

creating a better place

Planning and Building Control  
Walsall Metropolitan Borough Council  
The Civic Centre  
Darwall Street  
Walsall  
WS1 1DG



Our ref: WML335

Your ref:

Date: 03-10-07

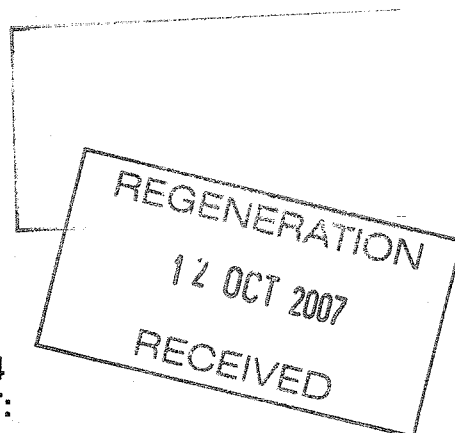

Dear Sir or Madam,

**ENVIRONMENTAL PROTECTION ACT 1990  
WASTE MANAGEMENT LICENSING REGULATIONS 1994  
APPLICATION FOR WASTE MANAGEMENT LICENCE AT:**

**Fryers Road, Bloxwich, West Midlands**

I have received an application for a waste management licence for the above-named facility under Section 36 of the Environmental Protection Act 1990 (EPA 1990). Section 36(4) requires that the Agency consult you on the proposal. Please find enclosed a copy of the waste management licence application for the above site together with the draft site licence conditions.

Under Section 36(2) of the EPA 1990, a licence cannot be issued unless planning permission, if required under the Town and Country Planning Act 1990, is in force or the facility enjoys an established use certificate. I should be grateful if you would advise me about the current planning status of the facility. Where any required planning permission is in force, under Section 36(3) of the EPA 1990 the application cannot be rejected unless rejection is necessary for the purposes of preventing pollution of the environment or harm to human health.

Please regard this as a formal consultation and let me have any comments you wish to make within 28 days. Should you have any queries regarding the contents of this letter please do not hesitate to contact this office. The period for consultation may be extended by prior agreement for applications of unusual difficulty. Please contact me at the address below if this is likely to be the case.

Yours sincerely,

**Richard Toseland**  
**Permitting Support Advisor**  
Direct Dial: 0114 2800649  
E-mail: [psc@environment-agency.gov.uk](mailto:psc@environment-agency.gov.uk)

Enc.: Application Form & Draft Licence

Permitting Support Centre  
PO Box 4209  
Sheffield  
S9 9BS





TO: WML Consultation Responses  
FROM: LPA  
REF: WML 335

**ENVIRONMENTAL PROTECTION ACT 1990, SECTION 37  
WASTE MANAGEMENT LICENSING**

**SITE: Fryers Road, Bloxwich, West Midlands**

**APPLICATION TYPE:** New licence

I acknowledge receipt of your letter dated 03-10-07 requesting my observations on the above proposal.

- ☐ I have no comments on the proposals
- ☐ My comments will be forwarded under separate cover
- ☐ My comments are as follows:-

(Please tick as appropriate)

Signed ..... Date .....

Print Name ..... Department .....

**Please return to: Permitting Support Centre  
PO Box 4209  
Sheffield  
S9 9BS**







## DRAFT Licence Number EAWML 100130

### with Introductory Note

## Facility Type: Household, Commercial and Industrial Waste Transfer Station with Treatment

Environmental Protection Act 1990

Licence holder: J.P.E. Holdings Ltd  
Specified land: Land at Fryers Road,  
Bloxwich  
West Midlands WS3 2XJ

### Contents

|                                   |    |
|-----------------------------------|----|
| INTRODUCTORY NOTE .....           | 2  |
| LICENCE .....                     | 4  |
| CONDITIONS .....                  | 5  |
| 1- MANAGEMENT .....               | 5  |
| 2- OPERATIONS .....               | 5  |
| 3- EMISSIONS AND MONITORING ..... | 6  |
| 4- INFORMATION .....              | 7  |
| SCHEDULE 1- SITE PLAN .....       | 9  |
| SCHEDULE 2 - OPERATIONS .....     | 10 |
| SCHEDULE 3 - INTERPRETATION ..... | 18 |

---

## Introductory note

This introductory note does not form a part of the licence

This licence permits the holder to operate a Household, Commercial and Industrial Waste Transfer Station with waste treatment at the specified location. The inputs are limited to non-hazardous and inert wastes and do not include hazardous wastes such as asbestos. Wastes of similar types will be transferred into larger containers and sent to other waste facilities for further treatment or recovery. Wastes can be bulked up for recovery elsewhere and also can be treated by sorting, separation, screening, baling, shredding, crushing and compaction of waste. This licence does not permit the burning of any wastes, either in the open, inside buildings or in any form of incinerator.

This is a bespoke licence.

This licence does not allow any emission into surface waters or groundwater. However:

- Liquids may be discharged into a sewer subject to a consent issued by the sewerage undertaker.
- Liquids may be tankered off-site for disposal or recovery.

Clean surface water from roofs, or from areas of the site that are not being used in connection with the storage and treatment of waste, may be discharged directly to surface waters, or to groundwater by percolation through the soil via a soakaway.

## Operational requirements specified in regulations

Some aspects of the activity are not controlled by the conditions of this licence, because the controls are specified in the Waste Management Licensing (WML) Regulations<sup>1</sup>, or other legislation. These include:

- Regulation 4 of the WML Regulations describes the qualifications required by a technically competent person at a waste management facility.
- Section 33 (1)(c) of the Environmental Protection Act 1990 prohibits the treating, keeping or disposal of controlled waste in a manner which causes or is likely to cause pollution of the environment or harm to human health.
- Section 85 of the Water Resources Act 1991 under which it is an offence to cause or knowingly permit polluting matter to enter controlled waters (which include both surface and ground waters) unless the discharge is specifically allowed in a permit.
- The Oil Storage Regulations<sup>2</sup> require oil storage tanks to be bunded.

## Public Registers

The public registers in Environment Agency offices contain information relating to licences including the application and monitoring results. Certain information may be withheld from public registers where it is commercially confidential or contrary to national security. Some information is also available on the Environment Agency's website (see below).

## Appeals against the conditions in the licence

The licence holder may appeal to the Secretary of State against any of the conditions imposed by this licence, within 6 months of the date of issue.

---

## **Licence modifications, transfers and surrender**

The Environment Agency may modify the conditions of this licence in the future. If the licence holder wishes to modify the conditions, transfer the licence to another person or surrender the licence then he must submit an application to the Environment Agency.

## **Other permits at this location**

There may be other environmental permits at this location, issued to different operators/licence holders or to the same operator/licence holder for different activities. There may also be permits issued by another regulator such as the local authority. For information on any other Environment Agency-issued permits please contact the Environment Agency (see below).

This waste management licence does not remove the licence holder or operator from their obligations under any other legislation.

## **Talking to us**

Please quote the licence number if you contact the Environment Agency about this licence.

In the event of an incident the Environment Agency may be contacted using the Incident Hotline telephone number (0800 80 70 60). Calls are free and the hotline operates 24 hours a day, 7 days a week.

For routine enquiries during office hours, the Environment Agency contact telephone number is 08708 506 506. Alternatively you can write to the Environment Agency local office (at the address given in the phone book) or go to the Environment Agency website at [www.environment-agency.gov.uk](http://www.environment-agency.gov.uk) where you can: complete an enquiry form on-line, look up the site under "what's in your backyard", or search for other information.

<sup>1</sup> - The Waste Management Licensing Regulations 1994 (SI 1994 No. 1056), (as amended).

<sup>2</sup> - The Control of Pollution (Oil Storage) (England) Regulations 2001 (SI2001 No. 2954)

*End of Introductory Note.*

## Draft Licence

Environmental Protection Act 1990  
Waste Management Licensing  
Regulations 1994



Environment  
Agency

### Waste Management Licence Number EAWML100130 Facility Type: Household Commercial and Industrial Waste Transfer Station with Treatment

The Environment Agency ("the Agency") in exercise of its powers under section 36 of the Environmental Protection Act 1990, hereby authorises:

**J.P.E.Holdings Ltd** ("the licence holder"),

whose registered office is

**The Lodge, Warstone Road, Essington, Wolverhampton, Staffordshire WV11 2AR**

Company registration number: **03019120**

to carry out the keeping and treatment of waste at

**Land off Fryers Road, Bloxwich, West Midlands. WS3 2XJ**

the boundary of which is shown on the site plan at schedule 1 to this licence

to the extent authorised by and subject to the conditions of this licence.

Signed

Date

|  |  |
|--|--|
|  |  |
|--|--|

XXXXXXXXXX, (National Permitting Service Team Leader)

Authorised to sign on behalf of the Agency

---

# Conditions

## 1 – MANAGEMENT

### 1.1 General management

- 1.1.1 The activities shall be managed and operated:
- (a) in accordance with a management system, which identifies and minimises risks of pollution, including those arising from operations, maintenance, accidents, incidents and non-conformances and those drawn to the attention of the licence holder as a result of complaints; and
  - (b) by sufficient persons who are competent in respect of the responsibilities to be undertaken by them in connection with the operation of the activities.
- 1.1.2 Records demonstrating compliance with condition 1.1.1 shall be maintained.
- 1.1.3 Any persons having duties that are or may be affected by the matters set out in this licence shall have convenient access to a copy of it kept at or near the place where those duties are carried out.

### 1.2 Accident management plan

- 1.2.1 The licence holder shall:
- (a) maintain and implement an accident management plan;
  - (b) review and record at least every 4 years or as soon as practicable after an accident, (whichever is the earlier) whether changes to the plan should be made;
  - (c) make any appropriate changes to the plan identified by a review.

### 1.3 Site security

- 1.3.1 Site security measures shall prevent unauthorised access to the site, as far as practicable.

## 2 – OPERATIONS

### 2.1 Licensed activities

- 2.1.1 The licence holder is authorised to carry out the activities specified in schedule 2, table 2.1 ("the activities").

### 2.2 Waste acceptance

- 2.2.1 Waste shall only be accepted if:
- (a) it is of a type and quantity listed in schedule 2, table 2.2; and
  - (b) it conforms to the description in the documentation supplied by the producer and holder.

- 
- 2.2.2 Records shall be maintained of all waste accepted onto the site.

## **3 – EMISSIONS AND MONITORING**

### **3.1 Emissions to air, water or land**

- 3.1.1 There shall be no point source emissions to air, water or land.

### **3.2 Transfers off-site**

- 3.2.1 Records of all the wastes sent off site from the activities, for either disposal or recovery shall be maintained.

### **3.3 Fugitive emissions of substances**

- 3.3.1 Fugitive emissions of substances (excluding odour and noise) shall not cause pollution. The licence holder shall not be taken to have breached this condition if appropriate measures have been taken to prevent or where that is not practicable, to minimise, those emissions.
- 3.3.2 Litter or mud arising from the activities shall not cause pollution. The licence holder shall not be taken to have breached this condition if appropriate measures have been taken to prevent or where that is not practicable, to minimise, the litter and mud.
- 3.3.3 Litter and mud arising from the activities shall be cleared from affected areas outside the site as soon as practicable.
- 3.3.4 All liquid wastes, whose emission to water or land could cause pollution, shall be provided with secondary containment, unless the licence holder has used other appropriate measures to prevent or where that is not practicable, to minimise, leakage and spillage from the primary container.

### **3.4 Odour**

- 3.4.1 Emissions from the activities shall be free from odour at levels likely to cause annoyance outside the site, as perceived by an authorised officer of the Agency, unless the licence holder has used appropriate measures to prevent or where that is not practicable, to minimise, the odour.

### **3.5 Noise**

- 3.5.1 Emissions from the activities shall be free from noise at levels likely to cause annoyance outside the site, as perceived by an authorised officer of the Agency, unless the licence holder has used appropriate measures to prevent or where that is not practicable, to minimise, the noise.

### **3.6 Pests**

- 3.6.1 Scavenging animals, scavenging birds and other pests shall not cause pollution. The licence holder shall not be taken to have breached this condition if appropriate measures have been taken to prevent or where that is not practicable, to minimise, such pollution.

---

### **3.7 Monitoring**

- 3.7.1 This licence does not require any monitoring of the activities, emissions or the environment.

## **4 – INFORMATION**

### **4.1 Records**

- 4.1.1 All records required to be made by this licence shall:
- (a) be legible;
  - (b) be made as soon as reasonably practicable;
  - (c) if amended, be amended in such a way that the original and any subsequent amendments remain legible or are capable of retrieval; and
  - (d) be retained, unless otherwise agreed by the Agency, for at least 6 years from the date when the records were made, or in the case of the following records until licence surrender:
    - (i) off-site environmental and health effects; and
    - (ii) the condition of land and groundwater.
- 4.1.2 Any records required to be made by this licence shall be supplied to the Agency within 14 days, where the records have been requested in writing by the Agency.

### **4.2 Reporting**

- 4.2.1 All reports and notifications required by the licence shall be sent to the Agency using the contact details supplied in writing by the Agency.
- 4.2.2 A summary report of the waste types and quantities accepted and removed from the site shall be made for each quarter. It shall be submitted to the Agency within one month of the end of the quarter and shall be in the format required by the Agency.

### **4.3 Notifications**

- 4.3.1 The Agency shall be notified without delay following the detection of:
- (a) any malfunction, breakdown or failure of equipment or techniques, accident or fugitive emission which has caused, is causing or may cause significant pollution;
  - (b) the breach of a limit specified in this licence; and
  - (c) any significant adverse environmental and health effects.
- 4.3.2 Written confirmation of actual or potential pollution incidents and breaches of emission limits shall be submitted within 24 hours.
- 4.3.3 Prior written notification shall be given to the Agency of the following events and in the specified timescales:
- (a) as soon as practicable prior to the permanent cessation of any of the activities;
  - (b) cessation of operation of all or part of the activities for a period likely to exceed 3 months;
  - (c) resumption of the operation of all or part of the activities after a cessation notified under (b) above

- 
- 4.3.4 Where the Agency has requested in writing that it shall be notified when the licence holder is to undertake monitoring and/or spot sampling, the licence holder shall inform the Agency when the relevant monitoring is to take place. The licence holder shall provide this information to the Agency at least 14 days before the date the monitoring is to be undertaken.
- 4.3.5 The Agency shall be notified within 7 days of any changes in technically competent management and the name of any incoming person together with evidence that such person has the required technical competence.
- 4.3.6 The Agency shall be notified within 14 days of the licence holder and/or any relevant person being convicted of a relevant offence, (unless such information has already been notified to the Agency), with details of the nature of the offence, the place and date of conviction, and the sentence imposed.
- 4.3.7 The Agency shall be notified within 14 days of the licence holder and/or any relevant person lodging an appeal against a conviction for any relevant offence and of the outcome when the appeal is decided.
- 4.3.8 The Agency shall be notified within 14 days of the occurrence of the following matters except where such disclosure is prohibited by Stock Exchange rules:
- a) Where the licence holder is a registered company:
    - any change in the licence holder's trading name, registered name or registered office address
    - any change to particulars of the licence holder's ultimate holding company (including details of an ultimate holding company where a licence holder has become a subsidiary);
    - any steps taken with a view to the licence holder going into administration, entering into a company voluntary arrangement or being wound up; and
    - if the licence holder is not the operator: any change in the operators trading name; address; registered name or registered office address.
  - b) Where the licence holder is a corporate body other than a registered company:
    - any change in the licence holder's name or address;
    - any steps taken with a view to the dissolution of the licence holder; and
    - if the licence holder is not the operator: any change in the operators trading name; address; registered name or registered office address.
  - c) In any other case:
    - the death of any of the named licence holders (where the licence holder consists of more than one named individual);
    - any steps taken with a view to the licence holder, or any one of them, going into bankruptcy, entering into a composition or arrangement with creditors, or, in the case them being in a partnership, dissolving the partnership; and
    - if the licence holder is not the operator: any change in the operators trading name; address; registered name or registered office address.
- 4.3.9 The Agency shall be notified at least 7 days in advance of the commencement of any of the activities.

## 4.4 Interpretation

- 4.4.1 In this licence the expressions listed in schedule 3 shall have the meaning given in that schedule.



---

## Schedule 1- Site plan

DRAFT

## Schedule 2 - Operations

**Table 2.1 Licensed activities**

| Description of activities   | Limits of activities  |
|---|---|
| <b>R13:</b> Storage of waste pending any of the operations listed in paragraphs 1 to 12 of this Part of this Schedule, but excluding temporary storage, pending collection, on the site where it is produced. | <p>All bulking or transfer of non-hazardous waste must be carried out inside a building.</p> <p>Non-hazardous wastes must be kept in a building or within a secure container. Non-hazardous waste must be kept on an impermeable surface with sealed drainage.</p> <p>Inert wastes must be kept on hard standing or on an impermeable surface with sealed drainage.</p> |
| <b>R3:</b> Recycling or reclamation of organic substances which are not used as solvents, including composting and other biological transformation processes.   | Treatment consisting of manual sorting, separation, screening, baling, shredding, crushing or compaction of non-hazardous or inert waste into different components for recovery.  |
| <b>R4:</b> Recycling or reclamation of metals and metal compounds   | Treatment of non-hazardous waste must be carried out within a building.   |
| <b>R5:</b> Recycling or reclamation of other inorganic materials  | <p>Non-hazardous waste must be treated on an impermeable surface with sealed drainage.</p> <p>Inert wastes may be treated by processing through a washing plant.</p> <p>Inert wastes must be treated on hard standing or on an impermeable surface with sealed drainage.</p>  |

**Table 2.2 Licensed waste types and quantities**

### Maximum Quantities

The quantity of wastes listed below, accepted at the site shall be less than 250,000 tonnes a year.

### Exclusions

Notwithstanding the specification of waste types below, wastes shall not be accepted at the site which have any of the following characteristics:

- Consisting solely or mainly of dusts, powders or loose fibres
- Wastes that are in a form which is either sludge or liquid

| Waste Code | Description  |
|------------|--|
| <b>01</b>  | <b>WASTES RESULTING FROM EXPLORATION, MINING, QUARRYING, AND PHYSICAL AND CHEMICAL TREATMENT OF MINERALS</b> |
| 01 01      | wastes from mineral excavation   |
| 01 01 01   | wastes from mineral metalliferous excavation   |

| Table 2.2 Licensed waste types and quantities |  |
|---|--|
| 01 01 02                                      | wastes from mineral non-metalliferous excavation   |
| 01 03   | wastes from physical and chemical processing of metalliferous minerals   |
| 01 03 06                                      | tailings other than those mentioned in 01 03 04 and 01 03 05   |
| 01 03 09                                      | red mud from alumina production other than the wastes mentioned in 01 03 07  |
| 01 04   | wastes from physical and chemical processing of non-metalliferous minerals   |
| 01 04 08                                      | waste gravel and crushed rocks other than those mentioned in 01 04 07  |
| 01 04 09                                      | waste sand and clays   |
| 01 04 11                                      | wastes from potash and rock salt processing other than those mentioned in 01 04 07   |
| 01 04 12                                      | tailings and other wastes from washing and cleaning of minerals other than those mentioned in 01 04 07 and 01 04.11  |
| 01 04 13                                      | wastes from stone cutting and sawing other than those mentioned in 01 04 07  |
| <b>02</b>                                     | <b>WASTES FROM AGRICULTURE, HORTICULTURE, AQUACULTURE, FORESTRY, HUNTING AND FISHING, FOOD PREPARATION AND PROCESSING</b>  |
| 02 01   | wastes from agriculture, horticulture, aquaculture, forestry, hunting and fishing  |
| 02 01 03                                      | plant-tissue waste   |
| 02 01 04                                      | waste plastics (except packaging)  |
| 02 01 07                                      | wastes from forestry   |
| 02 01 10                                      | waste metal  |
| 02 02   | wastes from the preparation and processing of meat, fish and other foods of animal origin  |
| 02 02 03                                      | materials unsuitable for consumption or processing   |
| 02 03   | wastes from fruit, vegetables, cereals, edible oils, cocoa, coffee, tea and tobacco preparation and processing; conserve production; yeast and yeast extract production, molasses preparation and fermentation |
| 02 03 04                                      | materials unsuitable for consumption or processing   |
| 02 04   | wastes from sugar processing   |
| 02 04 01                                      | soil from cleaning and washing beet  |
| 02 04 02                                      | off-specification calcium carbonate  |
| 02 05   | wastes from the dairy products industry  |
| 02 05 01                                      | materials unsuitable for consumption or processing   |
| 02 06   | wastes from the baking and confectionery industry  |
| 02 06 01                                      | materials unsuitable for consumption or processing   |
| 02 06 02                                      | wastes from preserving agents  |
| 02 07   | wastes from the production of alcoholic and non-alcoholic beverages (except coffee, tea and cocoa)   |
| 02 07 01                                      | wastes from washing, cleaning and mechanical reduction of raw materials  |
| 02 07 02                                      | wastes from spirits distillation   |
| 02 07 04                                      | materials unsuitable for consumption or processing   |
| <b>03</b>                                     | <b>WASTES FROM WOOD PROCESSING AND THE PRODUCTION OF PANELS AND FURNITURE, PULP, PAPER AND CARDBOARD</b>   |
| 03 01   | wastes from wood processing and the production of panels and furniture   |
| 03 01 01                                      | waste bark and cork  |
| 03 01 05                                      | sawdust, shavings, cuttings, wood, particle board and veneer other than those mentioned in 03 01 04  |
| 03 03   | wastes from pulp, paper and cardboard production and processing  |

|           |  |
|-----------|--|
| 03 03 01  | waste bark and wood  |
| 03 03 07  | mechanically separated rejects from pulping of waste paper and cardboard                     |
| 03 03 08  | wastes from sorting of paper and cardboard destined for recycling                            |
| 03 03 10  | Fibre rejects, fibre-, filler- and coating-sludges from mechanical separation                |
| <b>04</b> | <b>WASTES FROM THE LEATHER, FUR AND TEXTILE INDUSTRIES</b>                                   |
| 04 01     | Wastes from the leather and fur industry   |
| 04 01 08  | waste tanned leather (blue sheetings, shavings, cuttings, buffing dust) containing chromium  |
| 04 01 09  | wastes from dressing and finishing   |
| 04 02     | wastes from the textile industry   |
| 04 02 21  | wastes from unprocessed textile fibres   |
| 04 02 22  | wastes from processed textile fibres   |
| <b>06</b> | <b>WASTES FROM INORGANIC CHEMICAL PROCESSES</b>  |
| 06 09     | wastes from the MSFU of phosphorous chemicals and phosphorous chemical processes             |
| 06 09 02  | phosphorous slag   |
| 06 09 04  | calcium-based reaction wastes other than those mentioned in 06 09 03                         |
| 06.11     | wastes from the manufacture of inorganic pigments and opacifiers                             |
| 06 11 01  | calcium-based reaction wastes from titanium dioxide production                               |
| <b>07</b> | <b>WASTES FROM ORGANIC CHEMICAL PROCESSES</b>  |
| 07 02     | wastes from the MSFU of plastics, synthetic rubber and man-made fibres                       |
| 07 02 13  | waste plastic  |
| <b>09</b> | <b>WASTES FROM THE PHOTOGRAPHIC INDUSTRY</b>   |
| 09 01     | wastes from the photographic industry  |
| 09 01 07  | photographic film and paper containing silver or silver compounds                            |
| 09 01 08  | photographic film and paper free of silver or silver compounds                               |
| 09 01 10  | single-use cameras without batteries   |
| 09 01 12  | single-use cameras containing batteries other than those mentioned in 09 01.11               |
| <b>10</b> | <b>WASTES FROM THERMAL PROCESSES</b>   |
| 10 01     | wastes from power stations and other combustion plants (except 19)                           |
| 10 01 01  | bottom ash, slag and boiler dust (excluding boiler dust mentioned in 10 01 04)               |
| 10 01 05  | calcium-based reaction wastes from flue-gas desulphurisation in solid form                   |
| 10 01 07  | calcium-based reaction wastes from flue-gas desulphurisation in sludge form                  |
| 10 01 15  | bottom ash, slag and boiler dust from co-incineration other than those mentioned in 10 01 14 |
| 10 01 19  | wastes from gas cleaning other than those mentioned in 10 01 05, 10 01 07 and 10 01 18       |
| 10 01 24  | sands from fluidised beds  |
| 10 02     | wastes from the iron and steel industry  |
| 10 02 01  | wastes from the processing of slag   |
| 10 02 02  | unprocessed slag   |
| 10 02 08  | solid wastes from gas treatment other than those mentioned in 10 02 07                       |
| 10 02 10  | mill scales  |
| 10 02 14  | filter cakes from gas treatment other than those mentioned in 10 02.13                       |

|          |  |
|----------|--|
| 10 02 15 | other filter cakes   |
| 10 03    | wastes from aluminium thermal metallurgy   |
| 10 03 02 | anode scraps   |
| 10 03 05 | waste alumina  |
| 10 03 16 | skimmings other than those mentioned in 10 03 15   |
| 10 03 18 | carbon-containing wastes from anode manufacture other than those mentioned in 10 03 17           |
| 10 03 24 | solid wastes from gas treatment other than those mentioned in 10 03.23                           |
| 10 03 26 | filter cakes from gas treatment other than those mentioned in 10 03.25                           |
| 10 03 28 | wastes from cooling-water treatment other than those mentioned in 10 03.27                       |
| 10 03 30 | wastes from treatment of salt slags and black drosses other than those mentioned in 10 03.29     |
| 10 04    | wastes from lead thermal metallurgy  |
| 10 04 10 | wastes from cooling-water treatment other than those mentioned in 10 04 09                       |
| 10 05    | wastes from zinc thermal metallurgy  |
| 10 05 01 | slags from primary and secondary production  |
| 10 05 09 | wastes from cooling-water treatment other than those mentioned in 10 05 08                       |
| 10 05 11 | dross and skimmings other than those mentioned in 10 05 10                                       |
| 10 06    | wastes from copper thermal metallurgy  |
| 10 06 01 | slags from primary and secondary production  |
| 10 06 02 | dross and skimmings from primary and secondary production  |
| 10 06 10 | wastes from cooling-water treatment other than those mentioned in 10 06 09                       |
| 10 07    | wastes from silver, gold and platinum thermal metallurgy   |
| 10 07 01 | slags from primary and secondary production  |
| 10 07 02 | dross and skimmings from primary and secondary production  |
| 10 07 03 | solid wastes from gas treatment  |
| 10 07 05 | filter cakes from gas treatment  |
| 10 07 08 | wastes from cooling-water treatment other than those mentioned in 10 07 07                       |
| 10 08    | wastes from other non-ferrous thermal metallurgy   |
| 10 08 09 | other slags  |
| 10 08 11 | dross and skimmings other than those mentioned in 10 08 10                                       |
| 10 08 13 | carbon-containing wastes from anode manufacture other than those mentioned in 10 08.12           |
| 10 08 14 | anode scrap  |
| 10 08 18 | filter cakes from flue-gas treatment other than those mentioned in 10 08 17                      |
| 10 08 20 | wastes from cooling-water treatment other than those mentioned in 10 08 19                       |
| 10 09    | wastes from casting of ferrous pieces  |
| 10 09 03 | furnace slag   |
| 10 09 06 | casting cores and moulds which have not undergone pouring other than those mentioned in 10 09 05 |
| 10 09 08 | casting cores and moulds which have undergone pouring other than those mentioned in 10 09 07     |
| 10 09 14 | waste binders other than those mentioned in 10 09.13   |
| 10 09 16 | waste crack-indicating agent other than those mentioned in 10 09 15                              |
| 10 10    | wastes from casting of non-ferrous pieces  |

|           |   |
|-----------|---|
| 10 10 03  | furnace slag  |
| 10 10 06  | casting cores and moulds which have not undergone pouring, other than those mentioned in 10 10 05   |
| 10 10 08  | casting cores and moulds which have undergone pouring, other than those mentioned in 10 10 07   |
| 10 10 14  | waste binders other than those mentioned in 10 10.13  |
| 10 10 16  | waste crack-indicating agent other than those mentioned in 10 10 15   |
| 10 11     | wastes from manufacture of glass and glass products   |
| 10 11 03  | waste glass-based fibrous materials   |
| 10 11 10  | waste preparation mixture before thermal processing, other than those mentioned in 10.11 09   |
| 10 11 12  | waste glass other than those mentioned in 10.11.11  |
| 10 11 16  | solid wastes from flue-gas treatment other than those mentioned in 10.11 15   |
| 10 11 18  | filter cakes from flue-gas treatment other than those mentioned in 10.11 17   |
| 10 12     | wastes from manufacture of ceramic goods, bricks, tiles and construction products   |
| 10 12 01  | waste preparation mixture before thermal processing   |
| 10 12 05  | filter cakes from gas treatment   |
| 10 12 06  | discarded moulds  |
| 10 12 08  | waste ceramics, bricks, tiles and construction products (after thermal processing)  |
| 10 12 10  | solid wastes from gas treatment other than those mentioned in 10.12 09  |
| 10 12 12  | wastes from glazing other than those mentioned in 10.12.11  |
| 10 13     | wastes from manufacture of cement, lime and plaster and articles and products made from them  |
| 10 13 01  | waste preparation mixture before thermal processing   |
| 10 13 04  | wastes from calcination and hydration of lime   |
| 10 13 07  | filter cakes from gas treatment   |
| 10 13 10  | wastes from asbestos-cement manufacture other than those mentioned in 10.13 09  |
| 10 13 11  | wastes from cement-based composite materials other than those mentioned in 10.13 09 and 10.13 10  |
| 10 13 13  | solid wastes from gas treatment other than those mentioned in 10.13.12  |
| 10 13 14  | waste concrete  |
| <b>11</b> | <b>WASTES FROM CHEMICAL SURFACE TREATMENT AND COATING OF METALS AND OTHER MATERIALS; NON-FERROUS HYDRO METALLURGY</b>   |
| 11 01     | wastes from chemical surface treatment and coating of metals and other materials (for example galvanic processes, zinc coating processes, pickling processes, etching, phosphating, alkaline degreasing, anodising) |
| 11 01 10  | filter cakes other than those mentioned in 11 01 09   |
| 11 01 14  | degreasing wastes other than those mentioned in 11 01.13  |
| 11 02     | wastes from non-ferrous hydrometallurgical processes  |
| 11 02 03  | wastes from the production of anodes for aqueous electrolytical processes   |
| 11 02 06  | wastes from copper hydrometallurgical processes other than those mentioned in 11 02 05  |
| 11 05     | wastes from hot galvanising processes   |
| 11 05 01  | hard zinc   |
| 11 05 02  | zinc ash  |
| <b>12</b> | <b>WASTES FROM SHAPING AND PHYSICAL AND MECHANICAL SURFACE TREATMENT OF METALS AND PLASTICS</b>   |
| 12 01     | wastes from shaping and physical and mechanical surface treatment of metals and plastics  |

|           |  |
|-----------|--|
| 12 01 01  | ferrous metal filings and turnings   |
| 12 01 03  | non-ferrous metal filings and turnings   |
| 12 01 05  | plastics shavings and turnings   |
| 12 01 13  | welding wastes   |
| 12 01 17  | waste blasting material other than those mentioned in.12 01 16   |
| 12 01 21  | spent grinding bodies and grinding materials other than those mentioned in.12 01.20  |
| <b>15</b> | <b>WASTE PACKAGING; ABSORBENTS, WIPING CLOTHS, FILTER MATERIALS AND PROTECTIVE CLOTHING NOT OTHERWISE SPECIFIED</b>  |
| 15 01     | packaging (including separately collected municipal packaging waste)   |
| 15 01 01  | paper and cardboard packaging  |
| 15 01 02  | plastic packaging  |
| 15 01 03  | wooden packaging   |
| 15 01 04  | metallic packaging   |
| 15 01 05  | composite packaging  |
| 15 01 06  | mixed packaging  |
| 15 01 07  | glass packaging  |
| 15 01 09  | textile packaging  |
| 15 02     | absorbents, filter materials, wiping cloths and protective clothing  |
| 15 02 03  | absorbents, filter materials, wiping cloths and protective clothing other than those mentioned in 15 02 02   |
| <b>16</b> | <b>WASTES NOT OTHERWISE SPECIFIED IN THE LIST</b>  |
| 16 01     | end-of-life vehicles from different means of transport (including off-road machinery) and wastes from dismantling of end-of-life vehicles and vehicle maintenance (except 13,14 16 06 and 16 08) |
| 16 01 03  | end-of-life tyres  |
| 16 02     | wastes from electrical and electronic equipment  |
| 16 02 14  | discarded equipment other than those mentioned in 16 02 09 to 16 02.13   |
| 16 02 16  | components removed from discarded equipment other than those mentioned in 16 02 15   |
| 16 03     | off-specification batches and unused products  |
| 16 03 04  | inorganic wastes other than those mentioned in 16 03 03  |
| 16 03 06  | organic wastes other than those mentioned in 16 03 05  |
| 16 06     | batteries and accumulators   |
| 16 06 04  | alkaline batteries (except 16 06 03)   |
| 16 06 05  | other batteries and accumulators   |
| 16 11     | waste linings and refractories   |
| 16 11 02  | carbon-based linings and refractories from metallurgical processes others than those mentioned in 16.11 01   |
| 16 11 04  | other linings and refractories from metallurgical processes other than those mentioned in 16.11 03   |
| 16 11 06  | linings and refractories from non-metallurgical processes others than those mentioned in 16.11 05  |
| <b>17</b> | <b>CONSTRUCTION AND DEMOLITION WASTES (INCLUDING EXCAVATED SOIL FROM CONTAMINATED SITES)</b>   |
| 17 01     | concrete, bricks, tiles and ceramics   |
| 17 01 01  | concrete   |
| 17 01 02  | bricks   |

|           |  |
|-----------|--|
| 17 01 03  | tiles and ceramics   |
| 17 01 07  | mixtures of concrete, bricks, tiles and ceramics other than those mentioned in 17 01 06  |
| 17 02     | wood, glass and plastic  |
| 17 02 01  | wood   |
| 17 02 02  | glass  |
| 17 02 03  | plastic  |
| 17 03     | bituminous mixtures, coal tar and tarred products  |
| 17 03 02  | bituminous mixtures other than those mentioned in 17 03 01   |
| 17 04     | metals (including their alloys)  |
| 17 04 01  | copper, bronze, brass  |
| 17 04 02  | aluminium  |
| 17 04 03  | lead   |
| 17 04 04  | zinc   |
| 17 04 05  | iron and steel   |
| 17 04 06  | tin  |
| 17 04 07  | mixed metals   |
| 17 04 11  | cables other than those mentioned in 17 04 10  |
| 17 05     | soil (including excavated soil from contaminated sites), stones and dredging spoil   |
| 17 05 04  | soil and stones other than those mentioned in 17 05 03   |
| 17 05 08  | track ballast other than those mentioned in 17 05 07   |
| 17 06     | insulation materials and asbestos-containing construction materials  |
| 17 06 04  | insulation materials other than those mentioned in 17 06 01 and 17 06 03   |
| 17 08     | gypsum-based construction material   |
| 17 08 02  | gypsum-based construction materials other than those mentioned in 17 08 01   |
| 17 09     | other construction and demolition wastes   |
| 17 09 04  | mixed construction and demolition wastes other than those mentioned in 17 09 01, 17 09 02 and 17 09 03   |
| <b>19</b> | <b>WASTES FROM WASTE MANAGEMENT FACILITIES, OFF-SITE WASTE WATER TREATMENT PLANTS AND PREPARATION OF WATER INTENDED FOR HUMAN CONSUMPTION/INDUSTRIAL USE</b> |
| 19 01     | wastes from incineration or pyrolysis of waste   |
| 19 01 02  | ferrous materials removed from bottom ash  |
| 19 01 12  | bottom ash and slag other than those mentioned in 19 01.11   |
| 19 01 18  | pyrolysis wastes other than those mentioned in 19 01 17  |
| 19 01 19  | sands from fluidised beds  |
| 19 02     | wastes from physico/chemical treatments of waste (including dechromatation, decyanidation, neutralisation)   |
| 19 02 03  | premixed wastes composed only of non-hazardous wastes  |
| 19 02 10  | combustible wastes other than those mentioned in 19 02 08 and 19 02 09   |
| 19 04     | vitrified waste and wastes from vitrification  |
| 19 04 01  | vitrified waste  |
| 19 05     | wastes from aerobic treatment of solid wastes  |
| 19 05 01  | non-composted fraction of municipal and similar wastes   |



|           |  |
|-----------|--|
| 19 05 02  | non-composted fraction of animal and vegetable waste   |
| 19 05 03  | off-specification compost  |
| 19.12     | wastes from the mechanical treatment of waste (for example sorting, crushing, compacting, pelletising) not otherwise specified                 |
| 19 12 01  | paper and cardboard  |
| 19 12 02  | ferrous metal  |
| 19 12 03  | non-ferrous metal  |
| 19 12 04  | plastic and rubber   |
| 19 12 05  | glass  |
| 19 12 07  | wood other than that mentioned in 19.12 06   |
| 19 12 08  | textiles   |
| 19 12 09  | minerals (for example sand, stones)  |
| 19 12 10  | combustible waste (refuse derived fuel)  |
| 19 13     | wastes from soil and groundwater remediation   |
| 19 13 02  | solid wastes from soil remediation other than those mentioned in 19.13 01  |
| <b>20</b> | <b>MUNICIPAL WASTES (HOUSEHOLD WASTE AND SIMILAR COMMERCIAL, INDUSTRIAL AND INSTITUTIONAL WASTES) INCLUDING SEPARATELY COLLECTED FRACTIONS</b> |
| 20 01     | separately collected fractions (except 15 01)  |
| 20 01 01  | paper and cardboard  |
| 20 01 02  | glass  |
| 20 01 08  | biodegradable kitchen and canteen waste  |
| 20 01 10  | clothes  |
| 20 01 11  | textiles   |
| 20 01 34  | batteries and accumulators other than those mentioned in.20 01.33  |
| 20 01 36  | discarded electrical and electronic equipment other than those mentioned in.20 01.21,.20 01.23 and.20 01.35                                    |
| 20 01 38  | wood other than that mentioned in.20 01.37   |
| 20 01 39  | plastics   |
| 20 01 40  | metals   |
| 20 01 41  | wastes from chimney sweeping   |
| 20 02     | garden and park wastes (including cemetery waste)  |
| 20 02 01  | biodegradable waste  |
| 20 02 02  | soil and stones  |
| 20 03     | other municipal wastes   |
| 20 03 01  | mixed municipal waste  |
| 20 03 02  | waste from markets   |
| 20 03 03  | street-cleaning residues   |
| 20 03 07  | bulky waste  |

---

## Schedule 3 – Interpretation

*"accident"* means an accident that may result in pollution.

*"authorised officer"* means any person authorised by the Agency under section 108(1) of The Environment Act 1995 to exercise, in accordance with the terms of any such authorisation, any power specified in Section 108(4) of that Act.

*"building"* means a construction that has the objective of providing sheltering cover and minimising emissions of noise, particulate matter, odour and litter

*"emissions to land"*, include emissions to groundwater.

*"fugitive emission"* means an emission to air, water or land from the activities which is not controlled by an emission limit.

*"groundwater"* means all water, which is below the surface of the ground in the saturation zone and in direct contact with the ground or subsoil.

*"impermeable surface"* means a surface or pavement constructed and maintained to a standard sufficient to prevent the transmission of liquids beyond the pavement surface, and should be read in conjunction with the term "sealed drainage system" (below).

*"notify/notified without delay"* means that a telephone call can be used, whereas all other reports and notifications must be supplied in writing, either electronically or on paper.

*"pollution"* includes pollution of the environment, harm to human health and serious detriment to the amenities of the locality, resulting from the licensed activities.

*"quarter"* means a calendar year quarter commencing on 1 January, 1 April, 1 July or 1 October.

*"relevant person"* and *"relevant offence"* shall have the meaning given to them in the Environmental Protection Act 1990

*"sealed drainage system"* in relation to an impermeable surface, means a drainage system with impermeable components which does not leak and which will ensure that:

- (a) no liquid will run off the surface otherwise than via the system;
- (b) except where they may lawfully be discharged, all liquids entering the system are collected in a sealed sump.

*"sewer"* means sewer within the meaning of section 219(1) of the Water Industry Act 1991.

*"technically competent management"* and *"technical competence"* shall be as prescribed under Section 74 of the Environmental Protection Act 1990.

*"waste code"* means the code specified in The List of Wastes (England) Regulations 2005 (SI 2005 No. 895) as amended, or The List of Wastes (Wales) Regulations 2005 (SI 2005 No.1820) (W.148) as amended. Codes marked with an \* are hazardous waste, as defined in those regulations. Licence conditions apply to those wastes listed with a six-digit code.

*"Waste Management Licensing Regulations"*, means The Waste Management Licensing Regulations 1994 (SI1994 No. 1056) (as amended).

*"year"* means calendar year commencing on 1<sup>st</sup> January.

17<sup>th</sup> July 2007

Please find enclosed a waste management licence application that was delivered to Wrens Court, Sutton Coldfield on 16/07/07. A cheque to the value of 8419.00 was received with it and is being stored in the safe at Wrens Court. Regards

Peter Levett  
Environment Officer  
0121 241 2061

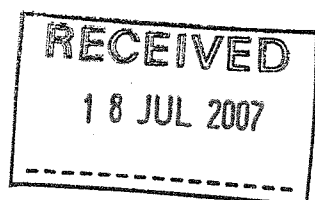



12 July 2007

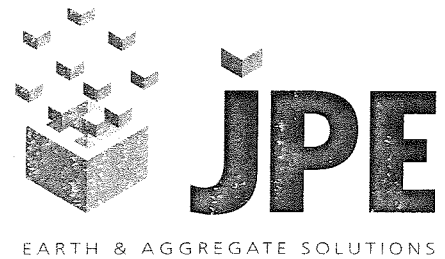

Mr Peter Levett  
Environment Agency  
Wrens Court  
15-17 Lower Queen Street  
Sutton Coldfield  
West Midlands  
B72 1BG

RECEPTION

16 JUL 2007

RECEIVED

Email: [johnhale@jpeaggregates.co.uk](mailto:johnhale@jpeaggregates.co.uk)  
Our Ref: 070712 EA ltr  
Your ref:

Dear Mr Levett,

**JPE HOLDINGS LTD – APPLICATION FOR A WASTE MANAGEMENT LICENCE  
AT FRYERS ROAD, BLOXWICH**

Please find enclosed 5 copies of an application for a Waste Management Licence for the operation of a Material Recovery Facility and Washing Plant on land at Fryers Road, Bloxwich. We enclose the necessary application forms, Working Plan and the appropriate fee.

We look forward to your confirmation of receipt as a duly made application.

Thanking you for your assistance in this matter.

Yours sincerely,

**John Hale**  
Director

PAID £8,419.00  
DATE 17/7/07  
REC No 120241

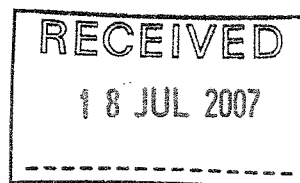



**Toseland, Richard**

---

**From:** Toseland, Richard  
**Sent:** 23 July 2007 12:41  
**To:** 'Steven Birch'  
**Subject:** RE: WML 335

Hello

I will be the contact until the application goes for technical assessment by our National Permitting Team. Once at NPT it will be assigned an officer, if you have any questions until that date please contact me.

Regards  
Richard  
PSC  
0114 2800649

---

**From:** Steven Birch [mailto:stevenbirch@jpeaggregates.co.uk]  
**Sent:** 23 July 2007 12:12  
**To:** Toseland, Richard  
**Subject:** RE: WML 335

Richard

I have put the original in the post, will you be our contact regarding this application?

Thank you for your assistance

Kind regards

Steven Birch FCCA  
Director



Telephone 01922475055  
Mobile 07802681706

This e-mail and any attachments are confidential and intended solely for the addressee and may also be privileged or exempt from disclosure under applicable law. If you are not the addressee, or have received this e-mail in error, please notify the sender immediately, delete it from your system and do not copy, disclose or otherwise act upon any part of this e-mail or its attachments.

Internet communications are not guaranteed to be secure or virus-free.

JPE Holdings Limited does not accept responsibility for any loss arising from unauthorised access to, or interference with, any Internet communications by any third party, or from the transmission of any viruses.

JPE Holdings Limited is Registered in England and Wales Company Number 3019120  
VAT Number 655 272919. Registered Office The Lodge, Warstone Road, Essington WV11 2AR.

23/07/2007





---

**From:** Toseland, Richard [mailto:[toselr.Sheffield1.NE@environment-agency.gov.uk](mailto:toselr.Sheffield1.NE@environment-agency.gov.uk)]  
**Sent:** 23 July 2007 12:05  
**To:** [stevenbirch@jpeaggregates.co.uk](mailto:stevenbirch@jpeaggregates.co.uk)  
**Subject:**

I have just received your fax.

Regards  
Richard Toseland  
Environment Agency

Information in this message may be confidential and may be legally privileged. If you have received this message by mistake, please notify the sender immediately, delete it and do not copy it to anyone else.

We have checked this email and its attachments for viruses. But you should still check any attachment before opening it.

We may have to make this message and any reply to it public if asked to under the Freedom of Information Act, Data Protection Act or for litigation. Email messages and attachments sent to or from any Environment Agency address may also be accessed by someone other than the sender or recipient, for business purposes.

If we have sent you information and you wish to use it please read our terms and conditions which you can get by calling us on 08708 506 506. Find out more about the Environment Agency at [www.environment-agency.gov.uk](http://www.environment-agency.gov.uk)

23/07/2007



**JPE Holdings Limited**

The Lodge  
Warstone Road  
Essington  
Wolverhampton  
WV11 2AR  
Tel: 01922 475055  
Fax: 01922 477354  
info@jpeaggregates.co.uk

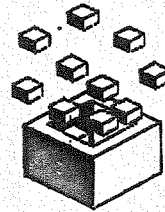

**JPE**

EARTH & AGGREGATE SOLUTIONS

## **Fax Message**

**To:** Environment Agency

**From:** Steve Birch

**Fax:** 01142626697

**Pages:** 3 pages inc this page

**Attn:** Richard Toseland

**Date:** 23/07/2007

**Re:** WML 1 Part f

**cc:**

Please find attached signed WML 1 Part F as discussed earlier.

If you have any queries please contact me on the number above

Kind regards

Mr S. J Birch  
Director



## Form WML 1 Part F

### F1 Data protection and confidentiality

The information you give will be used by the Environment Agency to process your application. It will be placed on the relevant public register(s), and used to monitor compliance with licence/permit conditions, or to process renewal applications.

We may also use and/or disclose any of the information you give us in order to:

- offer/provide you with our literature/services relating to environmental matters
- consult with the public, public bodies and other organisations (for example Health and Safety Executive, local authorities, emergency services, DEFRA on environmental issues
- carry out statistical analysis, research and development on environmental issues
- provide public register information to enquirers
- investigate possible breaches of environmental law and take any resulting action
- prevent breaches of environmental law
- assess customer service satisfaction and improve our service.

We may pass on the information to agents/representatives who we ask to do any of these things on our behalf.

Individuals have a right to see the information we hold about them. We will correct it if it is inaccurate.

You should ensure that any persons named on this form are informed of the contents of this data protection notice.

#### Disclosing information you give us in this application

The law says we must place your application on the public register unless you provide good reasons why it should stay confidential.

If you want any of the information in your application to remain confidential, enclose a letter with the completed application, giving your reasons in full.

We will let you know within 14 days if we agree that the information is confidential.

### F2 Declaration and signatures

If you knowingly or recklessly make a statement which is false or misleading for the purpose of obtaining a licence (for yourself or anyone else) or seeking the variation, transfer or surrender of a licence you may be

- committing an offence under Section 44 of the Environmental Protection Act 1990.

If you make a false statement

- we may prosecute you *and*
- if you are convicted, you are liable to a fine or imprisonment, (or both).



## Declaration

F2.0.1 I/we certify that the information in this application is correct. I/we apply

- ☒ for a new licence  
☐ to vary an existing licence  
☐ for a transfer of an existing licence *current operator(s) and proposed transferee must sign below*  
☐ to surrender an existing licence

In respect of the particulars described in this application (including supporting documentation I/we have supplied).

## Signatures

F2.0.2 Signature(s) of applicant (transferor in the case of licence transfer)

▼ The answer fields between this dotted marker and the next can be repeated as needed either by printing them out or using separate sheets. Include the question number on each sheet.

*Please note that each individual applicant must sign a paper copy of the declaration themselves, even if an agent is acting on their behalf.*

*For applications from*

- more than one person – all persons should sign below*
- a company or other corporate body – an authorised person should sign below*

Title, for example Mr, Ms, Dr

Mr

First name

STEVE J

Surname

BIRCH

Position or job title

DIRECTOR

Signature of applicant

S. Birch

Date

23-7-2007

A End of the repeatable answer fields.





**Toseland, Richard**

---

**From:** Toseland, Richard  
**Sent:** 23 July 2007 10:55  
**To:** 'stevenbirch@jpeaggregates.co.uk'  
**Subject:** WML335, WML Fryers Road

Hello

I have attached a link from where you can print off part F of the waste management licence application form;

[http://www.environment-agency.gov.uk/commondata/acrobat/wml\\_form\\_1361718.pdf](http://www.environment-agency.gov.uk/commondata/acrobat/wml_form_1361718.pdf)

Part F can then be signed and faxed to me on 0114 2626697.

It would be good if you could forward a hard copy to me at

Permitting Support Centre  
PO Box 4209  
Sheffield  
S9 9BS

please mark all correspondence FAO Richard Toseland and quote reference WML335

Thanks  
Richard Toseland  
0114 2800649

23/07/2007



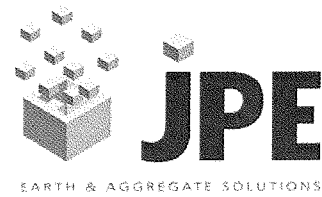

**ENVIRONMENTAL PROTECTION ACT 1990  
WASTE MANAGEMENT LICENSING REGULATIONS**

**APPLICATION FORMS FOR A WASTE MANAGEMENT LICENCE**

**WORKING PLAN**

**AND SUPPORTING DOCUMENTS FOR A**

**MATERIALS RECYCLING FACILITY**

**AND WASHING PLANT**

**ON LAND AT**

**FRYERS ROAD  
BLOXWICH WS3 2XJ  
W MIDLANDS**

**ON BEHALF OF  
JPE HOLDINGS LTD**

**JULY 2007**



**JPE Holdings Limited**

The Lodge  
Warstone Road  
Essington  
Wolverhampton  
WV11 2AR  
Tel: 01922 475055  
Fax: 01922 477354  
info@jpeaggregates.co.uk

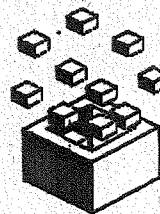
**JPE**

EARTH &amp; AGGREGATE SOLUTIONS

# Fax Message

**To:** Environment Agency**From:** Steve Birch**Fax:** 01142626697**Pages:** 3 pages inc this page**Attn:** Richard Toseland**Date:** 23/07/2007**Re:** WML 1 Part f**cc:**

Please find attached signed WML 1 Part F as discussed earlier.

If you have any queries please contact me on the number above

Kind regards

Mr S. J Birch  
Director



## Form WML 1 Part F

### F1 Data protection and confidentiality

The information you give will be used by the Environment Agency to process your application. It will be placed on the relevant public register(s), and used to monitor compliance with licence/permit conditions, or to process renewal applications.

We may also use and/or disclose any of the information you give us in order to:

- offer/provide you with our literature/services relating to environmental matters
- consult with the public, public bodies and other organisations (for example Health and Safety Executive, local authorities, emergency services, DEFRA on environmental issues
- carry out statistical analysis, research and development on environmental issues
- provide public register information to enquirers
- investigate possible breaches of environmental law and take any resulting action
- prevent breaches of environmental law
- assess customer service satisfaction and improve our service.

We may pass on the information to agents/representatives who we ask to do any of these things on our behalf.

Individuals have a right to see the information we hold about them. We will correct it if it is inaccurate.

You should ensure that any persons named on this form are informed of the contents of this data protection notice.

#### Disclosing information you give us in this application

The law says we must place your application on the public register unless you provide good reasons why it should stay confidential.

If you want any of the information in your application to remain confidential, enclose a letter with the completed application, giving your reasons in full.

We will let you know within 14 days if we agree that the information is confidential.

### F2 Declaration and signatures

If you knowingly or recklessly make a statement which is false or misleading for the purpose of obtaining a licence (for yourself or anyone else) or seeking the variation, transfer or surrender of a licence you may be

- committing an offence under Section 44 of the Environmental Protection Act 1990.

If you make a false statement

- we may prosecute you *and*
- if you are convicted, you are liable to a fine or imprisonment, (or both).





## Declaration

- F2.0.1 I/we certify that the information in this application is correct. I/we apply
- ☒ for a new licence
  - ☐ to vary an existing licence
  - ☐ for a transfer of an existing licence *current operator(s) and proposed transferee must sign below*
  - ☐ to surrender an existing licence
- In respect of the particulars described in this application (including supporting documentation I/we have supplied).

## Signatures

- F2.0.2 Signature(s) of applicant (transferor in the case of licence transfer)

▼ The answer fields between this dotted marker and the next can be repeated as needed either by printing them out or using separate sheets. Include the question number on each sheet.

*Please note that each individual applicant must sign a paper copy of the declaration themselves, even if an agent is acting on their behalf.*

*For applications from*

- more than one person – all persons should sign below
- a company or other corporate body – an authorised person should sign below

Title, for example Mr, Ms, Dr

MR

First name

STEVEN

Surname

BILCH

Position or job title

DIRECTOR

Signature of applicant

*[Handwritten Signature]*

Date

23-7-2007

▲ End of the repeatable answer fields.



## Declaration

- F2.0.1 I/we certify that the information in this application is correct. I/we apply
- ☒ for a new licence  
☐ to vary an existing licence  
☐ for a transfer of an existing licence *current operator(s) and proposed transferee must sign below*  
☐ to surrender an existing licence
- in respect of the particulars described in this application (including supporting documentation I/we have supplied).

## Signatures

- F2.0.2 **Signature(s) of applicant (transferor in the case of licence transfer)**
- Please note that each individual applicant must sign a paper copy of the declaration themselves, even if an agent is acting on their behalf.*
- For applications from*
- more than one person – all persons should sign below*
  - a company or other corporate body – an authorised person should sign below*

▼ The answer fields between this dotted marker and the next can be repeated as needed either by printing them out or using separate sheets. Include the question number on each sheet.

Title, for example Mr, Ms, Dr

Mr

First name

STEVEN

Surname

BIRCH

Position or job title

DIRECTOR

Signature of applicant

*[Handwritten Signature]*

Date

23-7-2007

▲ End of the repeatable answer fields.

24 JUL 2007





Environment  
Agency

#### How to apply

Please discuss your proposals with us before completing this form.

When you make your application, please make sure that you:

- Answer all the questions required. If you leave anything out, we will have to get in touch with you for the information. If any of the questions do not apply to you, please write 'Not applicable';
- Send the correct fees.

For further information, please see Background Note WM101- Applying for a waste management licence.

RECEIVED

18 JUL 2007

## Form WML 1 Part A

*The Waste Management Licensing Regulations 1994 state that an application should be made in writing. However, if you wish, you can enter the information electronically then sign the declaration at the end of Part F by hand. Each applicant must fill in Part A and complete and sign the declaration in Part F. The other parts to be filled in will depend on the type of application you are making.*

*If you are using the electronic version of this form, you will see only relevant questions, based on your answers to other questions: the form will adapt itself as you complete it. If you are using a paper version of the form, please read instructions carefully.*

*If you are applying for:*

- A new licence - fill in part A, then part B, and part F
- A licence modification - fill in part A, part C, and part F
- A licence transfer - fill in part A, part D, and part F
- A licence surrender - fill in part A, part E, and part F
- For new end of life vehicle (ELV) storage and treatment licence applications fill in Part A, Parts B2 to B7 and part F.

### A1 About your application

A1.0.1 What is your application for?

- ☒ New licence  
☐ New ELV licence  
☐ Variation of an existing licence  
☐ Transfer of an existing licence  
☐ Surrender of an existing licence

Does your application relate to a landfill site?

Applies if **Variation of an existing licence** on page 2 is ticked Applies if **Transfer of an existing licence** on page 2 is ticked Applies if **Surrender of an existing licence** on page 2 is ticked

*New landfill sites should be permitted under The Pollution Prevention and Control (England and Wales) Regulations 2000.*

- ☒ No  
☐ Yes: landfill variation, transfer or surrender

A1.0.2 Is your application for a site or for mobile plant?

- ☒ Site  
☐ Mobile plant

*Do not use this application form for 'mobile plant for the treatment of contaminated material, substances or products, for the purpose of remedial action with respect to land or controlled waters'. Please use the separate specific application form for this activity that is available.*

### A2 Authorised contacts

*It will help us to have someone who we can contact directly with any questions about your application. The person you name should have the authority to act on your behalf.*

A2.0.1 Who can we contact about your application?

*This could be an agent rather than the operator.*

Title, for example Mr, Ms, Dr

MR

First name

JOHN ALAN

Surname

HALE.

Position

TECHNICAL DIRECTOR

Address

Building name or number

THE LODGE

Street

WALSTONE ROAD

Locality

ESSINGTON

Town

WOLVERHAMPTON

County

STAFFORDSHIRE.

Postcode

WV11 2AR

Phone number

01922 475 055

Fax number

01922 477 354

Email address

john.hale@jpeaggregates.co.uk

## A3 About the applicant

*Please provide the information requested below about the 'applicant', which means:*

- for applications for a new licence – the person who wishes to hold the licence (if granted)
- for applications for the modification, transfer or surrender of a licence – the person who currently holds the licence.

*If you are applying for a licence transfer, we will ask for more information relating to the proposed new licence holder (transferee) in Part D.*

## A3.1 Applicant details

A3.1.1 Is the applicant an individual, a group of individuals, a partnership or a company/corporate body?

▼ The answer fields between this dotted marker and the next can be repeated as needed either by printing them out or using separate sheets. Include the question number on each sheet.

☐ Individual (sole trader) or group of individuals

Where more than one person is applying (other than as a partnership) we need details of each person. Click the 'add a person' button if you have more than one to list.

Trading name (if any)

Title, for example Mr, Ms, Dr

First name

Surname

Date of birth

Home address

Building name or number

Street

Locality

Town

County

Postcode

Phone number

Fax number

Email address

▲ End of the repeatable answer fields.



▼ The answer fields between this dotted marker and the next can be repeated as needed either by printing them out or using separate sheets. Include the question number on each sheet.

☐ Partnership

*We can only issue licences to named individuals, not to a partnership name. We therefore need details of each person in the partnership. Click the 'add a person' button if you have more than one to list.*

**A3.1.2 Person**

Title, for example Mr, Ms, Dr

First name

Surname

Date of birth

Home address

Building name or number

Street

Locality

Town

County

Postcode

Phone number

Fax number

Email address

▲ End of the repeatable answer fields.

**A3.1.3 Please give us the following details about the partnership**

Name of partnership (if there is one)

Address

Building name or number

Street

Locality

Town

County

Postcode

Phone number

Fax number

Email address

☒ Company or corporate body

Full name of company or corporate body

Trading business name if different

Registered office address

Building name or number

Street

Locality

Town

County

Postcode

Principal business address if different

Building name or number

Street

Locality

Town

County

Postcode

Company registration number

Date of company formation

Country of registration

*For applications from corporate bodies who are not limited companies, please provide evidence of status.*

Document reference number(s)

**A3.1.4 Is the applicant a subsidiary of a holding company within the meaning of Section 736 of the Companies Act (as amended) 1985?**

☒ No

☐ Yes

Name of holding company including interintermediaries or ultimate as appropriate

Registered office address

Building name or number

Street

Locality

Town

County

Postcode

Principal business address if different

Building name or number

Street

Locality

Town

County

Postcode

Company registration number

Date of company formation

## A3.2 Site operator

A3.2.1 Who will be operating the site?

- ☒ The applicant  
☐ Someone else/another company

Name and address

Name of operator

Trading business name if different

Building name or number

Street

Locality

Town

County

Postcode

Phone number

Fax number

Email address

☐ Not known

## Form WML 1 Part B Application for a new licence

### B1 Use of the site/plant

Applies if New licence on page 2 is ticked

B1.0.1 Please provide a brief description of the disposal and recovery operations proposed in this application

RECEIPT, STORAGE + TREATMENT OF MIXED COMMERCIAL + INDUSTRIAL WASTES (SKIP WASTE) THROUGH A MIX OF MECHANICAL + HAND SEPERATION PROCESSES TO RECOVER RECYCLATES INCLUDING TIMBER (TREATED + UNTREATED), PLASTICS FERROUS + NON FERROUS METALS, SOILS, CLAYS, ~~BRICK~~ BRICK, CONCRETE, CARD BOARD.

SOILS, CLAYS, BRICK + CONCRETE TO BE FURTHER PROCESSED THROUGH WASHING PLANT TO PRODUCE WASHED RECYCLED AGGREGATES FOR RESALE.

ALL OTHER RECOVERED MATERIALS TO BE SOLD OFF SITE FOR FURTHER TREATMENT/RECOVERY.

NON RECOVERABLE RESIDUES TO BE REMOVED TO LANDFILL.

## B1.1 Use of the site or plant

Please indicate the type of site applied for. Select one from **either** Section A or Section B

### Section A

#### Fixed and Bespoke Licences

You can apply for a Fixed Licence where:

- the activities are described within a current Fixed Licence type (please refer to current guidance to find out what type of activities are covered by fixed licences). Copies of Fixed Licences and Guidance are available on the Agency's website or by contacting our National Customer Contact Centre on 08708 506 506;
- the **site** will comply with the site specific criteria for that Fixed Licence type. Each Fixed Licence has a set of applicable criteria specific for that licence type, if your site does not meet these criteria then you cannot apply for a fixed licence. Site specific criteria for each Fixed Licence are listed in the introductory note for that fixed licence;
- you will only accept the **wastes categories** listed for that Fixed Licence type. Schedule 2 of each Fixed Licence lists the wastes you can accept. If you would like to accept wastes other than those listed then you cannot apply for a Fixed Licence;
- the **amount** of waste accepted at the site will be less than 75,000 tonnes per year.

**If you apply for a fixed licence do not answer questions B1.1.2, B1.1.3 and B2.4.2.**

You can apply for a Bespoke Licence where a site fits the description of a Fixed Licence activity but does not meet the Fixed Licence criteria, the waste categories or accepts 75,000 tonnes or over per year.

|                  |   |
|------------------|---|
| Application Type | <input type="radio"/> Fixed Licence<br><input checked="" type="radio"/> Bespoke Licence   |
| Activity Type    | <input type="radio"/> Household, Commercial and Industrial Waste Transfer Station<br><input checked="" type="radio"/> Household, Commercial and Industrial Waste Transfer Station with Treatment<br><input type="radio"/> Household, Commercial and Industrial Waste Transfer Station & Asbestos Storage<br><input type="radio"/> Household, Commercial and Industrial Waste Transfer Station with Treatment and Asbestos Storage<br><input type="radio"/> Asbestos Waste Transfer Station<br><input type="radio"/> Inert and Excavation Waste Transfer Station<br><input type="radio"/> Inert and Excavation Waste Transfer Station with Treatment<br><input type="radio"/> Non-hazardous Household Waste Amenity Site<br><input type="radio"/> Non-hazardous & Hazardous Household Waste Amenity Site<br><input type="radio"/> Composting in Open Windrows<br><input type="radio"/> Composting in Closed Vessels<br><input type="radio"/> Other (refer to guidance for additional fixed licences)<br>Please specify |

For Fixed Licences, please indicate the appropriate annual tonnage band for your site:

- ☐ 0 – 4,999 tonnes per year  
☐ 5,000 – 24,999 tonnes per year  
☐ 25,000 – 74,999 tonnes per year

**Section B**  
**Other Licences**

- ☐ Clinical Waste Transfer Station (standard licence)
- ☐ Handling and Storage of Waste Oil (standard licence )
- ☐ Toner Cartridge Storage (standard licence)
- ☐ Waste Refrigeration Equipment Storage (standard licence )
- ☐ Waste Refrigeration Equipment Destruction Unit (standard licence)
- ☐ Composting Facility
- ☐ Incinerator
- ☐ Storage at site of production
- ☐ Storage at site other than site of production
- ☐ Metal Recovery site (other than ELV storage and treatment)
- ☐ Biological treatment

Please specify process

- ☐ Chemical treatment

Please specify process

- ☒ Physical treatment

Please specify process

MECHANICAL + HAND SORTING, CRUSHING +  
WASHING

- ☐ Other process/recovery

Please give details

B1.1.2

*For Standard Licence applications you must rely on an Environment Agency generic risk assessment for the activity (please discuss further with your local Agency office).*

*For all other licence applications you must provide:*

- a) *list of waste types using the six-digit code from the List of Wastes (England) Regulations 2005 or the List of Wastes (Wales) Regulations 2005;*
- b) *an Environmental Risk Assessment. Guidance on Risk Assessment can be found in Environment Agency Guidance Note GN25;*
- c) *where applicable a working plan or a detailed description of the proposed activity and control measures.*

*An Access database containing the List of Wastes code is supplied on the CD which contains this application form. The database is also available on the Agency website.*

| List of Wastes Code | Waste Description |
|---------------------|-------------------|
| SEE ATTACHED        |                   |

B1.1.3

**Please summarise any other waste management activities to be carried out on the site, including exempt activities**

*For example, baling, sorting, screening, mixing, leachate treatment, shearing, shredding, etc.*

SORTING, SCREENING, CRUSHING, WASHING



JPE Holdings Ltd – Application for Waste Management Licence

Section B1.1.2 – Continuation Sheet

Permitted Wastes

| European Waste Classification | Description   |
|-------------------------------|---|
| 17.01.07                      | Mixtures of uncontaminated concrete, brick, tile and ceramics |
| 17.02.01                      | Wood  |
| 17.02.03                      | Plastic   |
| 17.05.04                      | Soil and stones   |
| 17.05.08                      | Track Ballast   |
| 20.01.01                      | Paper and cardboard   |

## B1.2 Mobile plant

Applies if **Mobile plant** on page 2 is ticked

*Please consult your local Agency office regarding supplementary information requirements such as working plans or risk assessments for mobile plant applications*

|        |   |  |
|--------|---|--|
| B1.2.1 | <b>What type of mobile plant does this application relate to?</b> | <input type="radio"/> An incinerator which is an exempt incinerator for the purposes of Section 5.1 of Schedule 1 to the 1991 Regulations;<br><input type="radio"/> Plant for-<br>(i) the recovery, by filtration or heat treatment, of waste oil from electrical equipment; or<br>(ii) the destruction by dechlorination of waste polychlorinated biphenyls or terphenyls (PCBs or PCTs); or<br>(iii) the collection and storage of a controlled substance from any waste product, installation or equipment;<br><input type="radio"/> Plant for the vitrification of waste;<br><input type="radio"/> Plant for the treatment of clinical waste;<br><input checked="" type="radio"/> Plant for the treatment of waste soil;<br><input checked="" type="radio"/> Plant for the dewatering of muds, sludges, soils and dredgings;<br><input type="radio"/> Plant for the treatment by lime stabilisation of sludge. |
|--------|---|--|

## B1.3 Site activities

Applies if **Site** on page 2 is ticked

|        |   |  |
|--------|---|--|
| B1.3.1 | <b>Do you intend to accept, treat or dispose of hazardous wastes at the site?</b> | <input checked="" type="radio"/> No<br><input type="radio"/> Yes   |
| B1.3.2 | <b>Are any of the activities above subject to any other regulatory control?</b>   | <p><i>For example, authorisation under Part 1 EPA 1990, Pollution Prevention and Control Regulations 2000 or authorisation under Part III of the Water Resources Act 1991 or part II of the Control of Pollution Act 1974</i></p> <input checked="" type="radio"/> No<br><input type="radio"/> Yes |

Please give details and enclose a copy of relevant authorising documents

## B2 The site

Applies if **New licence** on page 2 is ticked Applies if **Site** on page 2 is ticked  
Applies if **New ELV licence** on page 2 is ticked

### B2.1 Location

B2.1.1 Please give the address of the site

Building name or number

Street

Locality

Town

County

Postcode

Ordnance Survey national grid reference. 10 characters, for example SJ 1234 5678

*You must produce a site plan showing the area of land this application relates to (outlined in red). This area cannot be altered once a licence is issued.*

*The site plan should provide a date and a reference number, and must be drawn accurately to a defined scale.*

*For sites other than Fixed Licence type the following information should be clearly and accurately marked:*

- The site boundary, security and access;
- The waste reception areas;
- The waste handling and storage areas, including any buildings, bays and fixed tanks, areas of hardstanding, areas of impermeable pavement and sealed drainage systems (the maximum storage capacity, by area and/or volume, must be shown for each storage area or bay, by reference to clear physical markers or indicators provided in those areas or bays);
- Location of storage areas for specified waste types;
- Drainage systems for the site, including all interceptors, sumps and discharge points.

## B2.2 Occupancy

B2.2.1 Do you occupy the land this application relates to?

*We can only issue a site licence to a person who occupies or is entitled to occupy the land, for example, if they are owner-occupier, tenant or lessee. You must provide documentary evidence such as land registry entries, title deeds, lease agreement or solicitors letter confirming legal occupancy*

- ☐ No  
☒ Yes

Document reference of evidence to show you occupy the site

B2.2.2 What is your interest in the land?

*For example, owner-occupier, tenant or lessee*

Nature of interest

OWNER - OCCUPIER

B2.2.3 Does any other person have a legal right to use or gain access to the land?

- ☒ No  
☐ Yes

Please give details

## B2.3 Planning status

B2.3.1 Which of the following applies to the site?

- ☐ You have submitted an application for planning permission which has not yet been determined.

*We cannot issue a licence on this basis – one of the other options must apply by the time a licence is granted. We will need to see a copy of the relevant documents. Please provide a copy of the application.*

Document reference number

- ☒ You have planning permission.

Document reference number

- ☐ You have a certificate of lawful existing use or development.

Document reference number

- ☐ You have an established use certificate.

Document reference number

- ☐ The General Permitted Development Order 1995 applies.

Please give details

- ☐ Planning permission is not required

Please say why and provide written confirmation from the planning authority.

Document reference number

## B2.4 Environmental issues

B2.4.1 Are there any sites of special scientific interest (SSSIs) which are within 1km of the site?

- ☒ No  
☐ Yes

*You must provide an environmental risk assessment of the impact.*

Document reference number

B2.4.2 Are there any European Natura 2000 sites, as defined by regulation 40 of the Conservation of Habitats and Species Regulations 2002, within 1km of the site?

- ☒ No  
☐ Yes

## B3 Operation

Applies if **New licence** on page 2 is tickedApplies if **Site** on page 2 is tickedApplies if **New ELV licence** on page 2 is ticked

### B3.1 Capacity and throughput

| B3.1.1 Please tell us about the capacity and throughput for your site |                                  | For solids, please give total capacity in tonnes<br>For liquids and gases please state units used |   |
|---|----------------------------------|---|---|
| Waste Type  | Max storage capacity (all sites) | Max daily throughput (all sites other than Fixed Licences)  | Max annual throughput (all sites other than Fixed Licences) |
| Inert   | } 20,000 T                       | 1,000 T   | 250,000 T   |
| Non-hazardous   |                                  |   |   |
| Hazardous   |                                  |   |   |
| Metal   |                                  |   |   |
| End-of-life-vehicles  |                                  |   |   |

### B3.2 Timescales

B3.2.1 Please give the start date for preparatory work or for operations where no preparatory work is required.

*It might be a condition of the licence (if issued) to undertake site investigation works or an appropriate level of background monitoring if this has not already been done.*

Date

1 MARCH 2008

B3.2.2 Please give the proposed operating hours for the site.

Use the 24-hour clock

Weekdays

From

06.00

Until

22.00

Saturdays

From

06.00

Until

14.00

Sundays

From

06.00

Until

14.00

Variations from the above for

Receipt/removal of waste

AS ABOVE

Processing/handling of waste

AS ABOVE

Bank and other public holidays

No operation.

## B4 Relevant convictions

Applies if **New licence** on page 2 is ticked Applies if **New ELV licence** on page 2 is ticked

### Relevant offences

*We need to make sure that whoever holds the waste management licence is a 'fit and proper person'. This includes consideration of relevant offences, technical competence and financial provision.*

*A 'relevant person' includes each partner, director, manager, company secretary or any similar officer or can be an employee.*

*Please read background note **WM102***

#### B4.0.1 Who are the 'relevant people' in the company?

*Please give us details of each director, manager, company secretary and any other similar officer*

▼ The answer fields between this dotted marker and the next can be repeated as needed either by printing them out or using separate sheets. Include the question number on each sheet.

Title

MRS

First name

JOAN

Last name

PRICE

Position

DIRECTOR

Date of birth

27/03/48

▲ End of the repeatable answer fields.

JPE Holdings Ltd – Application for Waste Management Licence

**Section B4** Continuation Sheet

Relevant Persons:

Mr Steven Birch.  
Finance Director  
DOB: 23/08/71

Mrs Melissa Birch  
Co Secretary  
DOB: 17/10/72

  
9/7/07



B | Technical competence | Timescales

B4.0.2 Has the proposed licence holder, or any other 'relevant person', been convicted of any 'relevant offence'?

- ☒ No  
☐ Yes

*Please give full information.*

*The details we need are:*

- Full name of company or individual convicted.
- If an individual has been convicted please state their position at time of offence.
- Name of court.
- Date of conviction.
- Offence and penalty imposed.
- Date of any outstanding appeal lodged against conviction.
- Any additional information which the operator would like us to take into account in determining whether they are a 'fit and proper person'. For example, why the offence happened, and what has been done to prevent a similar event occurring.

Document reference number

## B5 Technical competence

Applies if **New licence** on page 2 is ticked Applies if **New ELV licence** on page 2 is ticked

*We need to make sure that whoever will hold the waste management licence will continue to be a 'fit and proper person'. For more details about technical competence please read the background notes **WM104** which came with this form or consult WAMITAB*

B5.0.1 Is the site/plant covered by the WAMITAB (Waste Management Industry Training Advisory Board) award scheme?

- ☐ No

Is the applicant seeking to satisfy technical competence by way of the transitional provisions in Regulation 4 of the Waste Management Regulations 1996?

- ☐ No  
☒ Yes

B5.0.2 Who will provide management for the proposed activities?

*Please give details for each person*

*For each person named below, we need to see a statement of qualifying experience and will want to carry out our own assessment.*

JPE Holdings Ltd – Application for Waste Management Licence

**Section B5.0.2 – Continuation Sheet**

Statement of Qualifying Experience

For

John Alan Hale

I am employed by JPE as Technical Director with specific responsibility for waste management, planning and similar technical issues.

I have 30 years experience in the minerals and waste industries in the UK and internationally.

More recently I provided consultancy advice on waste planning and licensing including the preparation of Waste Management Licence application and Working Plans. In this capacity, I have acted for both smaller independent waste companies as well as national operators.

Prior to these roles I was Managing Director for 15 years of a quarry and waste management company involved in waste carriage and landfill. During this time the waste management legislation introduced the requirements for technically competent management of waste sites and I gained a COTC at level 4 for landfill (then referred to as LB4).

As a consequence of this background, I am fully familiar with all current waste management legislation, including the duties and responsibilities that this imparts to companies handling waste, current drivers in the economics of waste management, European waste classification systems, and modern recycling techniques.

I have prepared this Working Plan on behalf of JPE and provide Technical Competence for the proposed site in so far as it has an extant closed landfill licence associated with part of it.



13/2/07

# WAMITAB

WASTE MANAGEMENT INDUSTRY TRAINING AND ADVISORY BOARD

CERTIFICATE No: 0289

## CERTIFICATE OF TECHNICAL COMPETENCE

*This Certificate confirms that*

**MR JOHN ALAN HALE**

has demonstrated the standard of technical competence required for the management of  
a facility of the type set out below

*Facility Type*

**MANAGING LANDFILL OPERATIONS:**

**BIODEGRADABLE WASTE (LEVEL 4) - LBA**



Authorising Signatures:

Director General

Director

Date of issue: 12 March, 1998

JPE Holdings Ltd – Application for Waste Management Licence

Section B5.0.2 – Continuation Sheet

Statement of Qualifying Experience

For

Dave Rogers

I have had several years experience in the waste management industry including 3 years as Site Foremen for Biffa Waste Services at Himley Wood Landfill, W Midlands. In this capacity I was responsible for overseeing the receipt of waste and its deposition in the landfill.

Subsequent to this position I was Assistant Manager with Cory Environmental at Himley Landfill, Kingswinford, W Midlands. Again I was responsible for all aspects of site operations within a landfill.

As a result of this background I am familiar with all the necessary waste management legislation including the Duty of Care, waste carriers responsibility and the importance of complying with environmental standards imposed on waste sites. I also have experience of the European Classification Waste Codes and the importance of these in recording of waste movement transactions.

I am currently Site Manager for JPE and responsible for restoring a completed quarry site under a Waste Exemption permit.

  
13/01/02

▼ The answer fields between this dotted marker and the next can be repeated as needed either by printing them out or using separate sheets. Include the question number on each sheet.

Title

MR

First name

JOHN ALAN

Last name

HALE

Position

TECHNICAL DIRECTOR

Date of birth

04/07/53

Document reference number for copy of certificate or statement

▲ End of the repeatable answer fields.

☐ Yes

Who will provide the technically competent management for the proposed activities?

Please give details for each person and provide a copy of the WAMITAB certificate.

▼ The answer fields between this dotted marker and the next can be repeated as needed either by printing them out or using separate sheets. Include the question number on each sheet.

Title

First name

Last name

Position

Level of WAMITAB certificate

Certificate date

Date of birth

Document reference number for copy of certificate

▲ End of the repeatable answer fields.

B5.0.3 Are any of these 'Responsible people' already providing the technically competent management at other sites licensed under Part II of the Environmental Protection Act 1990 or IPPC installations?

☐ No.  
☒ Yes

For each person we need to know the site/installation name and address and licence/permit reference number:

please provide details of these people.

MR JOHN ALAN HALE.

JPE Holdings Ltd – Application for Waste Management Licence

Section B5.0.1 Continuation Sheet

Technically Competent Persons:

Mr Dave Rogers.

Site Manager

DOB: 07/06/66

  
9/07/07

## B6 Financial provision

Applies if **New licence** on page 2 is ticked Applies if **New ELV licence** on page 2 is ticked

*You should demonstrate that you are of sufficient financial standing to hold a licence. The amount of financial provision considered suitable will be calculated on the basis of the waste types and amount of waste you intend to keep. Refer to **Guidance Note WML105** for more information.*

*The preferred method is by a credit reference.*

- ☒ Tick the box if you authorise the Agency to obtain a report on the financial standing of the applicant from a credit referencing agency

*Alternatively, you can provide us with evidence of financial standing or availability of funds. Please tick the appropriate box and provide evidence with the application:*

- ☐ Statement of account addressed to the applicant from a financial institution showing sufficient funds deposited.
- ☐ A letter from a financial institution to the applicant, to say that the applicant has sufficient overdraft or loan facilities.
- ☐ Local authorities may provide evidence that funds have been allocated in a named budget
- ☐ If you would like the Agency to consider an alternative method, describe it briefly below and provide details with the application

## Details of method

|  |
|--|
|  |
|--|

## B7 Checklist

Applies if **New licence** on page 2 is ticked

Applies if **New ELV licence** on page 2 is ticked

Please enclose the number of copies indicated

### For all applications:

- ☒ Completed application form *5 copies*
- ☒ Continuation sheets - numbered and cross-referenced to the question they apply to, dated and signed by the applicant *5 copies*
- ☐ Copy of other relevant authorising documents *1 copy*
- ☒ WAMITAB certificates or statements of qualifying experience and supporting documents (where relevant) *1 copy*
- ☒ Application fee payable to the 'Environment Agency' *For details about fees please consult the relevant Agency Charging form*
- ☐ Technical Competence Assessment fee *(if applicable)*
- ☒ Company registration or partnership documents *1 copy*
- ☐ Please tick this box if you have enclosed a letter telling us the reasons why some of the information on this form should be excluded from the public register. See 'Disclosing in-forma-tion you give us in this application'

### Required for all applications EXCEPT Mobile Plant

- ☒ Site location plan *5 copies*
- ☒ Evidence of land occupancy *1 copy*
- ☒ Planning permissions (or equivalent) and associated area plan *1 copy*

### Required for Bespoke Applications

- ☒ Working Plan or a detailed description of the proposed activity and control measures. *Where required. 5 Copies. Include:*
  - *A written statement;*
  - *Plans;*
  - *Detail drawings with a full contents list of plan titles, dates and unique plan/drawing reference numbers.**For details about working plans, please read the background notes WM103 which came with this form and discuss the proposals with us.*
- ☒ Signed copy of generic Agency risk assessment or site-specific risk assessment (for sites in Table B1.1 (section B) or as indicated in section B2.4).

**B7.0.1** Please list any other relevant documents included with this application.

List

|  |
|--|
|  |
|--|



## OFFICIAL COPY OF REGISTER ENTRIES

This official copy shows the entries subsisting on the register on 4 October 2006 at 15:13:41. This date must be quoted as the 'search from date' in any official search application based on this copy.

Under s.67 of the Land Registration Act 2002, this copy is admissible in evidence to the same extent as the original.

Issued on 4 October 2006.

This title is dealt with by Land Registry Coventry Office.

## Land Registry

Title Number : **WM402744**

Edition Date : 22 October 2004

### A: Property Register

*This register describes the land and estate comprised in the title.*

COUNTY

DISTRICT

WEST MIDLANDS

WALSALL

1. (06.04.1987) The **Freehold** land shown edged with red on the plan of the above Title filed at the Registry and being land on the south east side of Willenhall Lane, Bloxwich.
2. (21.11.2003) The land edged and numbered in green on the title plan has been removed from this title and registered under the title number or numbers shown in green on the said plan.

### B: Proprietorship Register

*This register specifies the class of title and identifies the owner. It contains any entries that affect the right of disposal.*

#### Title Absolute

1. (22.10.2004) PROPRIETOR: JPE (HOLDINGS) LIMITED (Co. Regn. No. 3019120) of 57-61 Market Place, Cannock, Staffs WS11 1BP and The Lodge, Upper Ryde Farm, Warstone Road, Essington, Staffs WS11 2AR.
2. (22.10.2004) The price stated to have been paid on 14 October 2004 was £437,500.

Title Number : WM402744

## **C: Charges Register**

*This register contains any charges and other matters that affect the land.*

1. The land is subject to the following rights granted by a Deed dated 13 January 1956 made between (1) The National Smelting Company Limited (Grantor) (2) Esau Squire and Basil Langford Squire (Occupiers) and (3) West Midlands Gas Board (the Board):-

"THE Grantor and the Occupiers as Beneficial Owners (and to the intent that the easements rights and privileges hereby granted shall be appurtenant to all such lands and hereditaments owned and occupied and used by the Board for the purpose of carrying out any of their duties imposed on the Board by the Act or by any statutory amendment or re-enactment thereof for the time being in force as are accommodated by the said easements rights and privileges and every part of such lands and hereditaments) hereby jointly and severally grant unto the Board ALL such easements rights and privileges as shall be necessary or proper or convenient to enable the Board and the successors in title of the Board to construct lay maintain inspect alter enlarge renew replace remove or render unusable a gas main or pipe and all necessary apparatus ancillary thereto for the distribution and storage of gas in the approximate position indicated by a red line on the said plan hereto annexed Together with such full and free right of access to the Grantor's property as may be necessary or proper or convenient for the use exercise and enjoyment of the easements rights and privileges hereby granted."

The said deed contains the following covenant by the Grantor

"THE Grantor and the Occupiers hereby covenant jointly and severally with the Board that the Grantor and the Occupiers will not do or permit or suffer to be done on the Grantor's property anything likely or calculated (a) to obstruct or impede in any way access to the said gas main or pipe and apparatus or (b) to cause damage or injury to the said gas main or pipe or apparatus and will take all necessary and proper precautions for the prevention of such damage or injury."

NOTE : The position of the red line referred to is a blue broken line on the filed plan.

2. (21.11.2003) The land is subject, during the term created by the lease of easements specified in the schedule of leases of easements hereto, to the rights granted by the said lease.

\*\*\*\*\*

## **Schedule of Leases of Easements**

1. Benefiting land : Land to the south of Willenhall Lane  
Title Number of  
benefiting land : WM815663  
Date of lease : 16 October 2003  
Term of lease : 125 years from 16.10.2003  
Registration date: 23.01.2004

---

**END OF REGISTER**

*NOTE: The date at the beginning of an entry is the date on which the entry was made in the Register.*

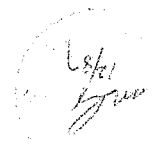



## TOWN AND COUNTRY PLANNING ACT 1990

### NOTIFICATION OF DECISION ON AN APPLICATION FOR PLANNING PERMISSION

**Applicant:** JPE Holdings Ltd  
**Agent:** Alliance Environment & Planning Ltd  
Halifax House,  
14/15 Frederick Road,  
Edgbaston,  
Birmingham,  
B15 1JD

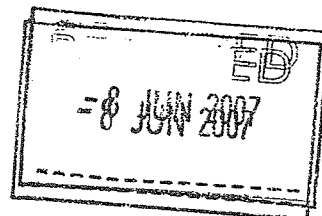

**Site:** LAND OFF, FRYERS ROAD, WALSALL, WEST MIDLANDS

**Application No:** 07/0449/OL/W7

**Particulars of Development:** Development of Industrial Units, Additional Access, Associated Internal Access Roads, Parking & Landscaping

Walsall Council, as Local Planning Authority, hereby **GRANTS** planning permission for the development described above, as shown in the plans which accompanied the application.

#### **Subject to the following conditions and reasons:**

1. Application for approval of the Reserved Matters shall be made not later than the expiration of 3 years beginning with the date of this permission. The development to which the permission relates must be begun not later than the expiration of 2 years from the final approval of the Reserved Matters application, or the last Reserved Matters approval.

**Reason:** Pursuant to the requirements of Section 92 of the Town and Country Planning Act 1990 (as amended).

This development shall not be commenced until details of the following Reserved Matters have been submitted to and approved by the Local Planning Authority:-

- a) The layout of the building(s); \*
- b) The appearance of the building(s); \*
- c) The scale of the building(s); \*
- d) The landscaping of the site \*



INVESTOR IN PEOPLE

GSC PAGE 1 OF 7

*Reason:* Pursuant to Article 3 (i) of the Town & Country Planning (General Development Procedure) Order 1995 (as amended).

2. The permitted development shall meet the 2005 Building Research Establishment Environmental Assessment Method 'very good' standard, unless otherwise agreed with the local planning authority. Details submitted in accordance with Condition 2 [the reserved matters], shall include details of eco friendly measures to be incorporated within the construction of the building. These shall be approved in writing by the Local Planning authority and provided prior to occupation and retained at all times in the future in accordance with details approved. These measures should address the following: a scheme for rainwater harvesting for reuse as part of the day to day functions of the building and landscaping maintenance within the design of the permitted development, details of rainwater discharge, details of a solar/photovoltaic system and/or micro wind energy system on roofs.

*Reason:* In order to comply with guidance within policies ENV39 and ENV40 of Walsall's Unitary Development Plan and PPS1 in terms of sustainable development and use of natural resources.

3. Details for the disposal of both surface water and foul sewage are to be submitted to and agreed by the Local Planning Authority prior to the commencement of the development hereby approved.

*Reason:* To ensure that the development is provided with a satisfactory means of drainage as well as to reduce the risk of creating or exacerbating a flooding problem and to minimise the risk of pollution.

4. No development shall be carried out until full details of the proposed boundary treatment of the site (including the boundary treatment to the proposed water features and roof terraces) have been approved in writing by the local planning authority. The approved scheme shall be implemented before the development is brought into use and shall be thereafter retained.

*Reason:* To ensure the satisfactory appearance of the development.

5. This development shall not be carried out until samples of the facing materials to be used have been approved in writing by the Local Planning Authority.

*Reason:* To ensure the satisfactory appearance of the development.

6. Prior to the commencement of development the details and locations of cycle stores and bin stores shall be completed submitted to and approved by the Local Planning Authority.



INVESTOR IN PEOPLE

GSC PAGE 2 OF 7

*Reason:* To ensure the satisfactory appearance of the development.

7. No development shall be carried out until a scheme for external lighting has been submitted to and approved by the Local Planning Authority and the lights shall be installed and thereafter retained in accordance with the approved details.

*Reason :* To safeguard the amenities of the occupiers of adjoining premises and highway safety.

8. Before this development is brought into use, the access ways, vehicle parking and manoeuvring areas shown on the approved plans shall be surfaced in a suitable impervious hardwearing material to be agreed in writing by the Local Planning Authority. The areas shall thereafter be retained and used for no other purpose. The parking spaces are to be clearly marked out.

*Reason:* To ensure the satisfactory functioning of the development.

9. Prior to the commencement of development details of street furniture (including proposed signage) shall be submitted to and approved in writing by the Local Planning Authority. The scheme shall be implemented in accordance with the approved details.

*Reason:* To ensure the satisfactory appearance of the development and to preserve and enhance the Conservation Area and neighbouring listed buildings.

10. Prior to the commencement of development the applicant shall submit to and agree in writing with the Local Planning Authority a Travel Plan, including measures taken to promote sustainable travel to and from the development. The approved Travel Plan shall be implemented in accordance with the approved details.

*Reason:* In order to promote the use of alternative modes of transport.

11. Prior to built development commencing details of a survey and assessment of ground gas conditions shall be undertaken following completion of the reclamation works and the results provided to the Local Planning Authority. Details of ground gas reclamation or ingress prevention measures identified by the survey and assessment shall be submitted to and agreed in writing with the Local Planning Authority prior to built development commencing. Buildings shall not be occupied until agreed works have been completed to the satisfaction of the Local Planning Authority.

*Reason:* To ensure the satisfactory development of the site.



INVESTOR IN PEOPLE

GSC PAGE 3 OF 7

**Note for applicant**

*Ground investigation surveys should have regard to current "Best Practice" and the advice and guidance contained in Planning Policy Statement 23 - Planning and Pollution Control; British Standard BS10175: 2001 "Investigation of potentially contaminated sites - Code of Practice"; British Standard BS5930: 1999 "Code of practice for site investigations"; Construction Industry Research and Information Association "Assessing risks posed by hazardous ground gasses to buildings" (CIRIA C659); or any relevant successors of such guidance. You are strongly advised to consult with the Local Planning Authority on the construction, location and potential retention of any boreholes installed for the purposes of ground gas and or groundwater before installation of same.*

**Prior to the commencement of development:**

- (a) An air quality survey and modelling has been undertaken, which demonstrates the impact or otherwise on air quality objectives in respect of Nitrogen Dioxide and PM<sub>10</sub> required by the provisions of the Environment Act 1995.
- (b) the methodology for such a survey and modeling has been submitted to and agreed in writing by the Local Planning Authority. The survey and modelling shall be undertaken in accordance with the approved details
- (c) Suitable mitigation measures shall be submitted to and approved in writing by the Local Planning Authority. The measures shall be implemented in accordance with the approved timetable, which should be no later than the first occupation of the development.

*Reason To ensure the satisfactory development of the site.*

13. Notwithstanding the provisions of the Town and Country Planning (Use Classes) Order 1987, and the Town and Country Planning (General Permitted Development) Order 1995, or succeeding Orders, the premises shall not be used solely for B1(a) office purposes. Any office use shall be ancillary to the primary use of the proposed buildings as B1(b), B1(c), B2 and/or B8 defined the Town and Country Planning (Use Classes) Order 1987.

*Reason: The site is not necessarily suitable for other uses.*

14. The development shall not be occupied until visibility splays shown on the approved plans have been provided at the junction with the public highway. The visibility splay(s) shall thereafter be kept free of all obstruction higher than 900mm above the adjoining carriageway level.



INVESTOR IN PEOPLE

*Reason* To ensure that the proposed development does not prejudice the free flow of traffic or conditions of general safety along the neighbouring highway.

15. The access hereby approved relates only to the position and size of the northern access point off Fryers Road and not to the internal road layout. The internal layout including parking, service areas and turning facilities are to be considered as a Reserved Matter as defined by Condition 2 of this permission.

*Reason:* In order to define the permission.

16. Built development shall not commence until a validation statement confirming the nature, extent and outcome of the works undertaken to implement reclamation of the site under Planning Approval 05/0641/FLW2 has been provided to and accepted in writing by the Local Planning Authority. This document shall contain sufficient detail to demonstrate that risk to groundwater has been removed or reduced to an acceptable level.

*Reason:* To ensure the satisfactory development of the site.

**NOTE FOR APPLICANT:** The applicant/developer is advised to contact Steve Lugg, British Waterways Third Party Works Engineer, in order to ensure that any necessary consent is obtained and that the works comply with British Waterways' "Code of Practice for Works affecting British Waterways".

**Summary of reasons for granting planning permission and the policies and proposals in the development plan which are relevant to the decision**

The proposed development is considered to comply with the relevant policies of the development plan, in particular policies GP1, GP2, GP3, GP7, T7, T12 T13, ENV18, ENV29, ENV32, ENV33, JP1, and JP7 of the Adopted Walsall Unitary Development Plan (March 2005) and Policies PA1, PA2, PA6, QE3, QE4, QE5 and QE9 of the Regional Spatial Strategy for the West Midlands (RSS11), on balance, having taken into account all material planning considerations, the proposal is acceptable.

Further details are available by referring to the officer's report which can be viewed, subject to availability, in Planning Services. If the application was approved by the Development Control Committee, the report can be viewed on the Council's web site at [www.walsall.gov.uk](http://www.walsall.gov.uk)



INVESTOR IN PEOPLE



Date of Decision: 06/06/2007

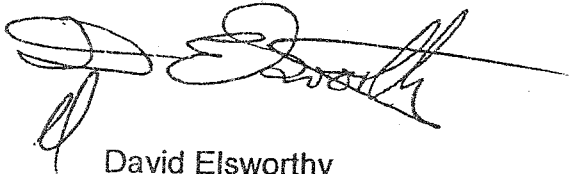

David Elsworthy  
Regeneration, Head of Planning and Building Control

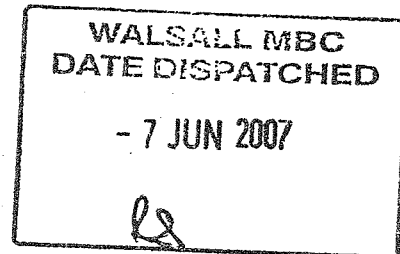

**OUR ATTENTION IS DRAWN TO THE ATTACHED NOTES**

**Notes for Applicant:**

- i This permission does not grant approval under the Building Regulations 2000 for which a separate application may be required. You are advised to contact the Building Control Section on telephone helpline number 01922 652408 should you require further advice.
- ii This permission does not grant approval or in any way overrides the requirement to comply with any restrictive covenant(s) that may be on the land. You should be aware that there is a risk involved in proceeding with development without clarifying whether there are any relevant covenants relating to the property.
- iii Your attention is drawn to the Party Wall Act 1996. If you intend to carry out building work which involves:
  - work on an existing wall shared with another property;
  - building on the boundary with a neighbouring property;
  - excavating near a neighbouring building;

you should find out whether that work falls within the scope of the Act. If it does, you must serve the statutory notice on all those defined by the Act as adjoining owners. You may wish to seek professional advice. However, two guidance booklets have been published entitled "The Party Wall etc. Act 1996: Explanatory Booklet" or "A Short Guide to the Party Wall etc. Act 1996", both are available from ODPM Free Literature, PO Box 236, Wetherby, West Yorkshire, LS23 7NB. Tel: 0870 1226 236, Fax: 0870 1226 237. This document is also available on the ODPM website: <http://www.safety.odpm.gov.uk/bregs/walls.htm>



INVESTOR IN PEOPLE

## NOTE

1. This notice does not constitute an Approval under the Building Regulations. This decision is given only under the Town and Country Planning Act 1990, and the Town and Country Planning (General Development Procedure) Order 1995. You are reminded of the need to ensure due compliance with the Building Regulations 1985 and to other legislation. Permission does not modify or affect any personal or retrospective covenant applying to the land or any right of any person entitled to the benefit thereof.
2. If you are aggrieved by the decision of the Council to refuse permission or approval for the proposed development, or grant permission or approval subject to conditions, you may appeal to the First Secretary of State **within six months of the date of this decision**. Appeals must be made on a form which is obtainable from the Planning Inspectorate, Temple Quay House, 2 The Square, Temple Quay, Bristol, BS1 6PN, or you can download the forms from the planning inspectorate's web site: [www.planning-inspectorate.gov.uk](http://www.planning-inspectorate.gov.uk). The First Secretary of State has power to allow a longer period for the giving of a notice of appeal but he will not normally be prepared to exercise this power unless there are special circumstances which excuse the delay in giving notice of appeal. The First Secretary of State is not required to entertain an appeal if it appears to him that permission for the proposed development could not have been granted by the Council, or could not have been so granted otherwise than subject to the conditions imposed by it, having regard to the statutory requirements, to the provisions of the development order, and to any decision of a Council was based on a direction given by him.
3. If permission to develop land is refused or granted subject to conditions, whether by the Council or by the First Secretary of State, and you claim that the land has become incapable of reasonably beneficial use by the carrying out of any development which has been or would be permitted, you may serve on the Council a purchase notice requiring the Council to purchase your land in accordance with the provisions of Part IX of the Town and Country Planning Act 1990. A notice may only be served on the Council by the owner of land concerned.
4. In certain circumstances, a claim may be made against the Council for compensation, where permission is refused or granted subject to the conditions by the First Secretary of State on appeal or on a reference of the application to him. The circumstances in which such compensation is payable are set out in Section 114 of the Town and Country Planning Act 1990.
5. Development must comply with Section 46 of the West Midlands County Council Act 1980 (namely it shall provide adequate means of access for the fire brigade to the building or, to the building as extended, as the case may be. It must be ensured that existing means of access for the fire brigade to a neighbouring building are not rendered inadequate).



INVESTOR IN PEOPLE

GSC PAGE 7 OF 7

**ENVIRONMENTAL PROTECTION ACT 1990  
WASTE MANAGEMENT LICENSING REGULATIONS**

**WORKING PLAN**

**MATERIALS RECYCLING FACILITY  
AND WASHING PLANT**

**LAND AT  
FRYERS ROAD  
BLOXWICH WS3 2XJ  
W MIDLANDS**

**ON BEHALF OF  
JPE HOLDINGS LTD**

**JULY 2007**

**WORKING PLAN**

**Contents**

**Introduction**

**1. Site Description and Characterisation of Risk Source**

- 1.1 Specified site and waste management operations
- 1.2 Permitted wastes
- 1.3 Hours of operation
- 1.4 Amendments to Working Plan and Supporting Information
- 1.5 Staffing and supervision
- 1.6 Relevant Convictions
- 1.7 Notification of Change of Operator or Licence Holder
- 1.8 Notification of Preparatory Works
- 1.9 Notification of commencement, cessation and re-commencement of waste handling operations

**2. Site Engineering for Pollution Prevention and Control**

- 2.1 Engineered site containment and drainage systems (includes effluent collection system)
- 2.2 Removal of residual wastes from site

**3. Site Infrastructure**

- 3.1 Provision of site identification board
- 3.2 Site security

**4. Site Operations**

- 4.1 Control of mud and debris
- 4.2 Potentially polluting leaks and spillages
- 4.3 Fires on site
- 4.4 Waste acceptance control systems and procedures
- 4.5 Waste quantity measurement systems

- 4.6 Storage of specified waste
- 4.7 Specified waste treatment process - plant, equipment and procedures

**5. Amenity Management and Monitoring**

- 5.1 Control, monitoring and reporting of dusts, fibres and particulates
- 5.2 Control of odours
- 5.3 Control and monitoring of noise
- 5.4 Control of pest infestations
- 5.5 Control of litter

**6. Site Records**

- 6.1 Security and availability of records
- 6.2 Records of waste movements
- 6.3 Site diary
- 6.4 Periodic reporting of environmental performance

**7. Health and Safety**

- 7.1 Policy Statement
- 7.2 Personnel
- 7.3 Equipment

**Appendices**

- 1. Health and Safety Policy and Procedures**
- 2. Plant and Equipment Schedule**
- 3. Risk Assessment**

**Figures**

- JPE/MRF/01 Site Location**
- JPE/MRF/02 Site Boundary**
- JPE/MRF/03 Site Layout**
- Washing Plant**
- MRF Plant**

**Introduction**

This Working Plan has been prepared in accordance with the Waste Management Licensing Regulations 1994 and sets out the considerations and operational details that are relevant to the operation of a materials recycling facility at Fryers Road, Bloxwich, W Midlands. WS3 2XJ.

The Working Plan accompanies an application for a Waste Management Licence submitted under the terms of the above Regulations and the Environmental Protection Act 1990.

The application relates to the use of part of the Fryers Road site as a Materials Recycling Facility (MRF) for the receipt and storage and processing of inert waste materials for their reuse as construction materials and other recycle streams.

The operation comprises the receipt of commercial and industrial (C&I) waste materials together with supplementary sources from selected construction and demolition waste streams. This feedstock will be reprocessed to form recycled aggregates and other construction materials (i.e. soils and fill) together with recyclates for further processing elsewhere (plastics, timber, metals, cardboard and paper). The MRF would receive waste predominantly from within EWC groups 17 (construction and demolition) and 20 (commercial and industrial fractions). No biodegradable or hazardous wastes would be accepted.

This Working Plan sets out the nature of the site, relevant plant and infrastructure works, methods of operation and environmental control.

All of the waste handling, storage and processing operations would be undertaken within specifically appointed areas located within the site as shown on Figure JPE/MRF/03.

# 1. Site Description and Characterisation of Risk Source

## 1.1 Specified site and waste management operations

1.1.1 The site is on land within the Fryers Road site as indicated on Figure JPE/MRF/01. Access is gained to the site via the main gates off Fryers Road. Operations to be carried out on the site are:

R4 Recycling/reclamation of other inorganic materials

R13 Storage of materials intended for operations above

(as defined in Annex II B of EC Framework Directive on Waste (91/156/EEC)).

**Table 1.1 Specified Waste Management Operations**

| Specified Waste Management Operation                        | Permitted Waste Types which may be subject To the Specified Operation | Limits On Specified Waste Management Operation                                   |
|---|---|--|
| Storage pending physical treatment (R13)                    | Those listed in Table 1.2   | 20,000T at any one time,   |
| Physical Treatment of wastes for recycling/reclamation (R4) | As above  | Treatment comprising physical sorting, screening, washing, shredding or chipping |

1.1.2 The application relates to the use of the site as a Materials Recycling Facility (MRF) for the receipt, storage and processing of commercial and industrial waste materials together with supplementary streams of selected construction and demolition wastes and for their reuse as construction materials or onward supply of other recyclates for further processing.

1.1.3 The operation comprises the receipt of these waste materials and their reprocessing (including washing) to form recycled aggregates and other

construction materials (i.e. soils and fill). The MRF would receive waste predominantly within EWC categories 17 and 20.

## **1.2 Permitted Wastes**

1.2.1 The Waste Licence application is for the receipt of inert wastes including commercial and industrial wastes (C&I) and selected construction and demolition (C&D) wastes, free from excessive contaminants.

Waste types to be processed at the site are set out in Table 1.2 below:

**Table 1.2 Permitted Wastes**

| <b>European Waste Classification</b> | <b>Description</b>  | <b>Maximum Permitted Quantity (subject to a combined capacity permitted in Table 1.1)</b> |
|--------------------------------------|---|---|
| 17.01.07                             | Mixtures of uncontaminated concrete, brick, tile and ceramics | 5,000T subject to site storage and treatment capacity as in Table 1.1                     |
| 17.02.01                             | Wood  | 2,500T subject to site storage and treatment capacity as in Table 1.1                     |
| 17.02.03                             | Plastic   | 500T subject to site storage and treatment capacity as in Table 1.1                       |
| 17.05.04                             | Soil and stones   | 5,000T subject to site storage and treatment capacity as in Table 1.1                     |
| 17.05.08                             | Track Ballast   | 5,000T subject to site storage and treatment capacity as in Table 1.1                     |
| 20.01.01                             | Paper and cardboard   | 500T subject to site storage and treatment capacity as in Table 1.1                       |

1.2.2 Any loads containing excessive levels of contaminants such as organic or biodegradable materials, plasterboard, oils or other liquids and any special wastes (as defined by the Special Waste Regulations) will be rejected and directed to an appropriate landfill site.



1.2.3 The site accepts waste streams from public utility and commercial contractors only and is not available for use by the general public.

1.2.4 Wastes types will be separately stored particularly those comprising source separated construction and demolition wastes. All wastes will be stored within the buildings provided as indicated on Figure JPE/MRF/03.

1.2.5 Non acceptable materials will be diverted to an appropriate alternative site as necessary.

### **1.3 Hours of operation**

1.3.1 The site will be open to receive wastes from 07.00 to 18.00 Monday to Friday and 07.00 to 13.00 on Saturdays. The site will be closed on Sundays and public holidays. The receipt of waste is also limited to daylight hours or where adequate lighting is available. Waste sorting operations will take place between the hours of 06.00-22.00 Monday – Friday and 06.00 – 14.00 Saturday.

1.3.2 Outside of these specified hours, receipt of wastes will be limited to emergency situations only. Such situations may include access to the site to allow off peak highway repairs to dispose of waste arisings. Such "emergency" openings will be limited to six per year and will be notified to the Agency at least 7 days in advance. Any other emergency use such as that resulting from vehicle breakdown will be notified to the Agency immediately thereafter.

### **1.4 Amendments to the Working Plan and Supporting Information**

1.4.1 Any proposed changes to the Working Plan or the operations within the specified area will be notified to the Agency and accompanied by an assessment of the risk to human health or the environment that such changes may pose.

1.4.2 Those changes requiring prior approval by the Agency shall not be implemented until such written approval is received. All other changes requiring pre

notification shall form part of the adopted Working Plan following notification to the Agency.

**1.5 Staffing and supervision**

1.5.1 The site is operated under the ultimate control of the Directors of the company but day to day responsibility rests with the Site Manager who will hold the appropriate level of competency.

1.5.2 The operation requires 25 full time employees who are supported as necessary by employees elsewhere within the Group. Staffing levels are sufficient to operate the site effectively throughout periods of employee sickness and holidays.

1.5.3 All staff are fully conversant with the requirements of the Licence and in particular the nature of acceptable wastes and the drainage control requirements.

1.5.4 The site falls within the requirements of Waste Management Paper No 4 and Circular 11/94 and the applicant's Site Manager is in the process of obtaining a formal COTC (4TMNH) under the WAMITAB scheme.

**1.6 Relevant Convictions**

1.6.1 The Licence holder will notify the Agency forthwith of any convictions or appealed convictions under waste management legislation.

1.6.2 Written notification will include details of the offence and any mitigating circumstances offered in defence.

**1.7 Notification of a Change of Operator or Licence Holder**

1.7.1 The Licence holder will notify the Agency within one week of any changes to its name, registered office or parent company. It will also provide advance notice of any application for administration or insolvency.

**1.8 Notification of preparatory works**

- 1.8.1 The site is part of a remediated industrial employment site with planning permission for the construction of industrial building and associated infrastructure.
- 1.8.2 These elements of the development of the site as an MRF have commenced including the provision of the buildings, access, weighbridge, surfacing and drainage control.
- 1.8.3 Any additional preparatory works required as a result of this issuing of a formal waste management licence would be notified to the relevant authority.
- 1.8.4 No wastes would be received until a validation report as to the adequacy of any preparatory works had been received from the Environment Agency.

**1.9 Notification of commencement, cessation and re-commencement of waste handling operations**

- 1.9.1 The Agency will be notified in writing one week prior to the commencement of waste handling within the site.
- 1.9.2 In the event of any future cessation and subsequent re-commencement, the relevant authorities would be notified in writing specifying the date of any such cessation or re-commencement.

**2 Site Engineering for Pollution Prevention and Control****2.1 Engineered site containment and drainage systems**

- 2.1.1 The site has been fully remediated and validated as such by the Environment Agency. As part of the remediation programme, there is a requirement for all engineering works related to further development of the site to maintain the integrity of the low permeability capping layer.
- 2.1.2 The remediation also required the control of future water infiltration through the containment of all surface water and its disposal to sewer.
- 2.1.3 As a consequence the site includes a fully integrated drainage system that takes into account the findings of a Flood Risk Assessment that was undertaken in support of the planning application for industrial units.
- 2.1.4 In addition to this strict control of surface water, all process water associated with the integral washing plant is re-circulated with no external, uncontrolled discharges.
- 2.1.5 Containment within the site is further enhanced through the enclosure of all waste related and waste storage activities.
- 2.1.6 No wastes will be handled within the site until such arrangements have been constructed and approved by the Agency.
- 2.2 Removal of residual wastes from site**
- 2.2.1 The load is inspected prior to offloading for unsuitable wastes and contaminants and will be rejected if these are present in significant quantities.

- 2.2.2 If accepted, the load will be allowed to tip in the waste storage area and a second visual check for buried contaminants and unsuitable wastes is made. Only those wastes listed within Table 1.2 are accepted at the site.
- 2.2.3 If non-conforming wastes are found to be present in any significant quantity, the material is reloaded onto the incoming vehicle and rejected from the site.
- 2.2.4 Details of all rejected loads are recorded in the site diary and recorded tonnages adjusted accordingly.
- 2.2.5 Loads which contain only minor quantities of non-conforming wastes are accepted in the knowledge that these wastes will be removed during the reprocessing and sorting operations. Containers are provided within the site (Figure JPE/MRF/03) for storing non-conforming wastes prior to disposal at an alternative, licensed site.
- 2.2.6 Non-conforming wastes will be removed from the containers provided, within 5 working days.

**3 Site Infrastructure****3.1 Provision of site identification board**

3.1.1 A site information notice as required under the Waste Management Licence is located at the highway entrance to the site (Figure JPE/MRF/02).

3.1.2 The notice contains all the required elements including opening hours, the operator's details, telephone number and Licence details as well as phone numbers for the Environment Agency and emergency numbers.

**3.2 Site Security**

3.2.1 The site is bounded on all sides by a 2.1m high galvanised palisade fence. Vehicular and pedestrian gates are provided at the entrance off Fryers Road. Outside of normal business hours these access points are locked and secured.

3.2.2 The site is also serviced by a rail spur off the main railway line complex owned by Network Rail. Access to this site from this method is also controlled by a locked gateway.

3.2.3 The site weighbridge function and operators provide continual supervision of all traffic movements in and out of the recycling facility.

3.2.4 All boundary fences and gates are checked on a regular basis for damage or signs of attempted entry. Such occurrences are entered in the site diary and any damage is repaired at the earliest opportunity.

**4 Site Operations****4.1 Control of mud and debris**

4.1.1 The access is checked daily for mud and other debris which may present a hazard to the highway. The fully surfaced site is sufficient to ensure that highway cleanliness can be maintained without recourse to specific wheel cleaning equipment.

4.1.2 However, high pressure hose equipment is available within the site for use as necessary in extreme conditions.

**4.2 Potentially polluting leaks and spillages**

4.2.1 Drains are inspected daily and cleaned at regular intervals to ensure that at no time does any surface water leave the site other than via the drainage control system. No surface water is allowed to contaminate local ditches or waterways.

4.2.2 Any incoming loads found to contain quantities of hazardous, difficult or potentially polluting wastes such as bonded asbestos, acid batteries or tyres, are isolated in a secure area and the Environment Agency contacted immediately for advice on handling and onward disposal.

4.2.3 Gas oil for use by mobile equipment is stored within the complex in a fully bunded surface tank. The installation is in accordance with recognised pollution prevention guidelines and is bunded with a sealed wall capable of containing 110% of the tank's capacity. Stock levels are checked regularly and recorded.

4.2.4 Servicing of plant and equipment is carried out within designated workshop facilities as indicated on Figure JPE/MRF/03. All consumables including oils and filters are contained and disposed of according to industry best practice using an oil recycling contractor.

4.2.5 Chemical absorbents are available for use in the event of accidental oil or fuel spillages. All loose oils and greases are stored in a secure container store within the workshops.

4.2.6 Equipment is maintained to the highest standards to minimise the potential for unexpected leaks or hose ruptures.

#### **4.3 Fires on site**

4.3.1 In the unlikely event of a minor fire within the site, fire hoses and extinguishers are available and employees have been trained in their correct use.

4.3.2 Extinguishers are fitted within the shovels and excavators. Fire escape doors are fitted throughout the buildings.

4.3.3 Assembly points in the event of an emergency are displayed at the weighbridge office.

4.3.4 In the event of a major fire, the entire area would be evacuated and the Fire Service called.

#### **4.4 Waste acceptance and control systems and procedures**

4.4.1 All incoming waste vehicles are required to proceed directly to the weighbridge as indicated on Figure JPE/MRF/03, where details of vehicle registration, source of waste and weight is recorded.

4.4.2 All loads are inspected prior to off loading to check for non-conforming wastes or contaminants which if found in a quantity which is incompatible with the Waste Management Licence, will cause the entire load to be rejected and removed from site.



- 4.4.3 If such unsuitable materials are found after the load has been tipped, it will be re-loaded and removed from site.
- 4.4.4 The nature of the wastes that are accepted under the Licence are such that they will occasionally contain small quantities of wastes for which the site is not licensed. These are removed and stored in the waste containers provided for subsequent removal from site. Such contaminant materials are not kept on site for more than 5 working days.
- 4.4.5 Details of any rejected loads are recorded in the site diary and the tonnage records adjusted accordingly.
- 4.4.6 All staff are well versed in the importance of only accepting wastes for which the site is licensed and the implications of contaminants in terms of both pollution potential and product contamination.
- 4.5 Waste quantity measurement systems**
- 4.5.1 All incoming waste loads and outgoing product loads are checked over a surface mounted 50 tonne capacity weighbridge approved for such use by Trading Standards.
- 4.5.2 The weighbridge is permanently manned during normal working hours and is used to weigh all sales from the complex including products from the MRF.
- 4.5.3 It is located as indicated on Figure JPE/MRF/03.
- 4.6 Storage of specified waste**
- 4.6.1 Within the reception building, there are separate storage locations for C&I waste streams and C&D wastes. This allows those wastes which do not require significant levels of sorting to be diverted directly to the aggregate washing section. The appropriate storage areas are clearly marked with their respective

contents and the location of the waste reception building is indicated on Figure JPE/MRF/03.

#### **4.7 Specified waste treatment process - plant, equipment and procedures**

##### **Mechanical and Hand Sorting (MRF)**

4.7.1 C&I waste streams are subject to sorting into waste types within an elevated picking station where bulk recyclates are recovered by hand and transferred to separate storage containers. To assist this process, fines are removed through a rough screening process prior to sorting by hand. A variety of air separation techniques are also employed. Blown or vacuumed materials are contained within sealed collection enclosures. Airflows are re-circulated through dust arresting systems.

4.7.2 Recyclates such as card and plastics are baled and stored within the buildings prior to despatch for further processing. Recovered metals are similarly stored in bulk containers for sale and removal from site.

##### **Crushing, washing and grading operations (washing plant)**

4.7.3 Hard recyclates and source segregated streams from C&D arisings are crushed as appropriate and fed to the adjacent washing facility where fines and clays are removed through a scrubbing process and the products separated in differing size fractions by screening.

4.7.2 Equipment used in the processes is listed in Appendix 3. This equipment is available on site on a permanent basis.

4.7.7 Fines and clays from the washing process are recovered, together with clean water for re-use in the washing plant, using a filter press system. This produces a low moisture filter cake which is removed to landfill for disposal.

**Throughput**

- 4.7.8 The site has a combined throughput capacity of around 250,000 tonnes per annum.
- 4.7.9 Details of each waste stream proposed to be handled within the site are set out in Section 1 above.

**Maintenance and Operation of Plant and Equipment**

- 4.7.10 A schedule of plant required on a regular basis for effective site operation is contained in Appendix 2.
- 4.7.11 Additional plant may be required to meet a specific, short-term need or during periods of peak activity.
- 4.7.12 The site operates a strict maintenance regime and all equipment is of sufficient capacity to allow down time for routine maintenance and servicing as recommended by the manufacturer.
- 4.7.13 Fluid and fuel levels are checked on all plant daily together with guard security and general condition. Any defects are reported to and logged by the Site Manager who will action the reports as necessary.
- 4.7.14 No plant may be operated unless full instructions and training have been given by a person competent to do so. No plant or equipment may be worked on for maintenance purposes unless it has been isolated to prevent an accidental start.
- 4.7.15 All newly arrived or hired in equipment is subject to particular scrutiny to ensure it meets the standards required by both the company and current legislation.
- 4.7.16 All breakdowns or incidents involving plant or equipment are entered in the site diary.

**5 Amenity Management and Monitoring****5.1 Control, monitoring and reporting of dusts, fibres and particulates**

5.1.1 The complex has the benefit of being fully surfaced and waste storage and processing takes place within purpose built buildings.

5.1.2 In keeping with industry best practice, speed limits are strictly enforced for all HGV vehicles.

5.1.2 Routeways are regularly dampened during excessively dry periods. This is achieved using a high-pressure hose system fitted with mist spray attachments.

5.1.3 Commencement of dust suppression measures is decided by the Site Manager based on the prevailing conditions and visual assessment of the potential for dust emissions to atmosphere.

5.1.4 Bulk loose loads are required to sheet vehicles prior to departure from site.

5.1.5 Crushing and screening equipment is fitted with dust suppression equipment as required and transfer heights are kept to a minimum. All process plant is located within buildings as is waste feed and products.

5.1.6 The site entrance is inspected daily for debris and dust that may be carried onto the public highway. Inspections are recorded in the site diary as are any problems requiring special attention such as hosing or mechanical sweeping.

**5.2 Control of odours**

5.2.1 The nature of the wastes received are such that odours from the site are minimal.

- 5.2.2 Should any problems be noted, the source would be identified and removed to a suitable landfill site immediately. Records of such occurrences and action taken are recorded in the site diary.

**5.3 Control and monitoring of noise**

- 5.3.1 All equipment used on site is attenuated to reduce noise emissions which are generally consistent with other activities within the general area. In particular, all equipment is properly silenced and maintained to manufacturer's recommendations to minimise noise emissions.

- 5.3.2 Additional noise attenuation is provided by housing all process operations within a building.

**5.4 Control of pest infestations**

- 5.4.1 Regular checks are made for evidence of vermin and rodents and remedial action taken when required. Reports of any incidents and the action taken is recorded in the site diary.

- 5.4.2 The site is also subject to an independent pest control contract who, in addition to providing regular monitoring, would be notified by site staff in the event of evidence being found between routine visits

**5.5 Control of litter**

- 5.5.1 Daily checks are made within and around the site for litter which may escape the sorting, collection and baling processes. Any incidents requiring particular attention are entered in the site diary.

- 5.5.2 Generally, such materials are sorted into the containers provided for this purpose and baled immediately to prevent escape.

**6 Site Records****6.1 Security and availability of records**

6.1.1 All site records including details of incoming wastes and outgoing products are kept in the weighbridge office.

6.1.2 These records are available during normal hours of business.

**6.2 Records of waste movements**

6.2.1 Waste movement details are maintained in the weighbridge office together with details of product sales and stock levels of unprocessed and processed materials.

6.2.2 Records are also maintained of any rejected loads and disposals of minor quantities of non-conforming wastes.

**6.3 Site diary**

6.3.1 The site diary is kept at the weighbridge office as with other records.

6.3.2 This is used to maintain a daily record of activities and occurrences within the site and includes information on such matters as:

- Rainfall (noting occurrence) and ambient conditions.
- Incidents involving fires, spillage or accidents (including nature, location within the site and action taken)
- Rejection and disposal of non-permitted wastes
- Condition of security gates and fencing (noting nature of any damage, apparent cause and remedial action taken)
- Condition and cleaning of drains
- Incidents of litter, dust, mud or vermin are noted together with action taken
- Details of equipment hired in and duration of operation

**6.4 Periodic reporting of environmental performance**

- 6.4.1 Records are maintained in the site diary of any complaints from surrounding properties in respect of the operations.

**7 Health and Safety****7.1 Policy Statement**

- 7.1.1 The company operates a strict health and safety policy (Appendix 1), and all employees are required to comply with it. Copies are issued to all new employees as part of their induction process, and it is available for reference in the weighbridge office.

**7.2 Personnel**

- 7.2.1 All contractors working on the site must comply with the company rules and provide copies of relevant certificates of competence and third party and employers liability insurance.
- 7.2.2 All staff are issued with and required to wear high visibility clothing, hard hats and safety footwear.
- 7.2.3 First aid facilities are provided at the weighbridge office, and a certificated first aider is always available within the complex.
- 7.2.4 Working during hours of darkness is limited to well lit areas.
- 7.2.5 Washroom and messroom facilities are provided within the complex as indicated on Figure JPE/MRF/03.

**7.3 Equipment**

- 7.3.1 All equipment and procedures used on site must comply with the relevant health and safety legislation and in particular HASWA 1974, PUWER 1998, Noise at Work Regulations 1989, COSHH, RIDDOR 1995 and PPEWR 1992.



## **Appendix 1**

### **Health and Safety Policy**

# HEALTH & SAFETY POLICY STATEMENT

Health and Safety at Work etc. Act 1974  
This is the Health and Safety Policy Statement of:

## JPE Holdings Limited

The Directors recognise and accept their responsibility to ensure, so far as is reasonably practicable, the health and safety of all its employees, contractors, visitors and those members of the public who may be affected by the Company's activities.

It is the Company's aim to promote, set and maintain the highest standards for health, safety and welfare matters. This will be achieved by:-

- providing adequate control of the health and safety risks arising from the work activities;
- maintaining secure and well managed sites;
- providing and maintaining safe plant and equipment;
- ensuring safe handling and use of substances;
- consulting with employees on matters affecting health and safety;
- providing information, instruction and supervision for employees;
- ensuring all employees are competent to do their tasks;
- preventing accidents and cases of work-related ill health;
- maintaining safe and healthy working conditions; and
- reviewing and revising this policy as necessary at regular intervals.

The company will endeavour to eliminate any hazards which may result in personal injury, industrial illness, fire, security losses, property damage or harm to the environment.

SIGNED: \_\_\_\_\_



Managing Director

Date: 21/4/06

Review Date: 20/4/07

## **Appendix 2**

### **Plant and Equipment Schedule**



## 1 SCOPE OF SUPPLY

The system is designed according to the attached layout drawings no. XXXXXXXX (see appendix 1).

Please consult chapter 2 for detailed description of the plant and chapter 3 for specifications of the equipment components.

To design, manufacture, supply install and commission a Wash and Silt Treatment System comprising of the following:

| REF # | Equipment Description                                   | QTY |
|-------|---|-----|
| 1     | Chieftain 1400 Feeder,c/w LiveHead                      | 1   |
| 2     | M100 Conveyor – with Magnet                             | 1   |
| 3     | 12x5 Static Rinser                                      | 1   |
| 4     | 120R Log Washer   | 1   |
| 5     | M100 Conveyor   | 1   |
| 6     | 12x5 Static Dry   | 1   |
| 7     | Fines Master 120  | 1   |
| 8     | 40-26 Conveyor  | 2   |
| 9     | Control Panel for Powerscreen Equipment                 | 1   |
| 10    | Automatic Flocculent Monitoring and Dosing System       | 1   |
| 11    | 9M Upward Flow Thickener Tank                           | 1   |
| 12    | Treated Water Buffer Tank 60m3                          | 1   |
| 13    | Fresh Water Pump to Washing Plant                       | 1   |
| 14    | Thickener Slurry Extraction Pump                        | 1   |
| 15    | Thickener Slurry Buffer Tank                            | 1   |
| 16    | Filer Press Feed Pump                                   | 1   |
| 17    | Filter Press Support Structure and Building Enclosure   | 1   |
| 18    | Overbeam Filter Press 1500x1500x110 Chamber x 25mm Cake | 1   |
| 19    | Filter Press Cloth Washing System                       | 1   |
| 20    | Flocculent Preparation and Dosing System                | 1   |
| 21    | Lockable Shipping Containers                            | 1   |
| 22    | Interconnecting Pipe Work                               | 1   |
| 23    | Electrical Control Panel                                | 1   |
| 24    | Air compressor with Galvanised Vertical Air Reservoir   | 1   |

1:100

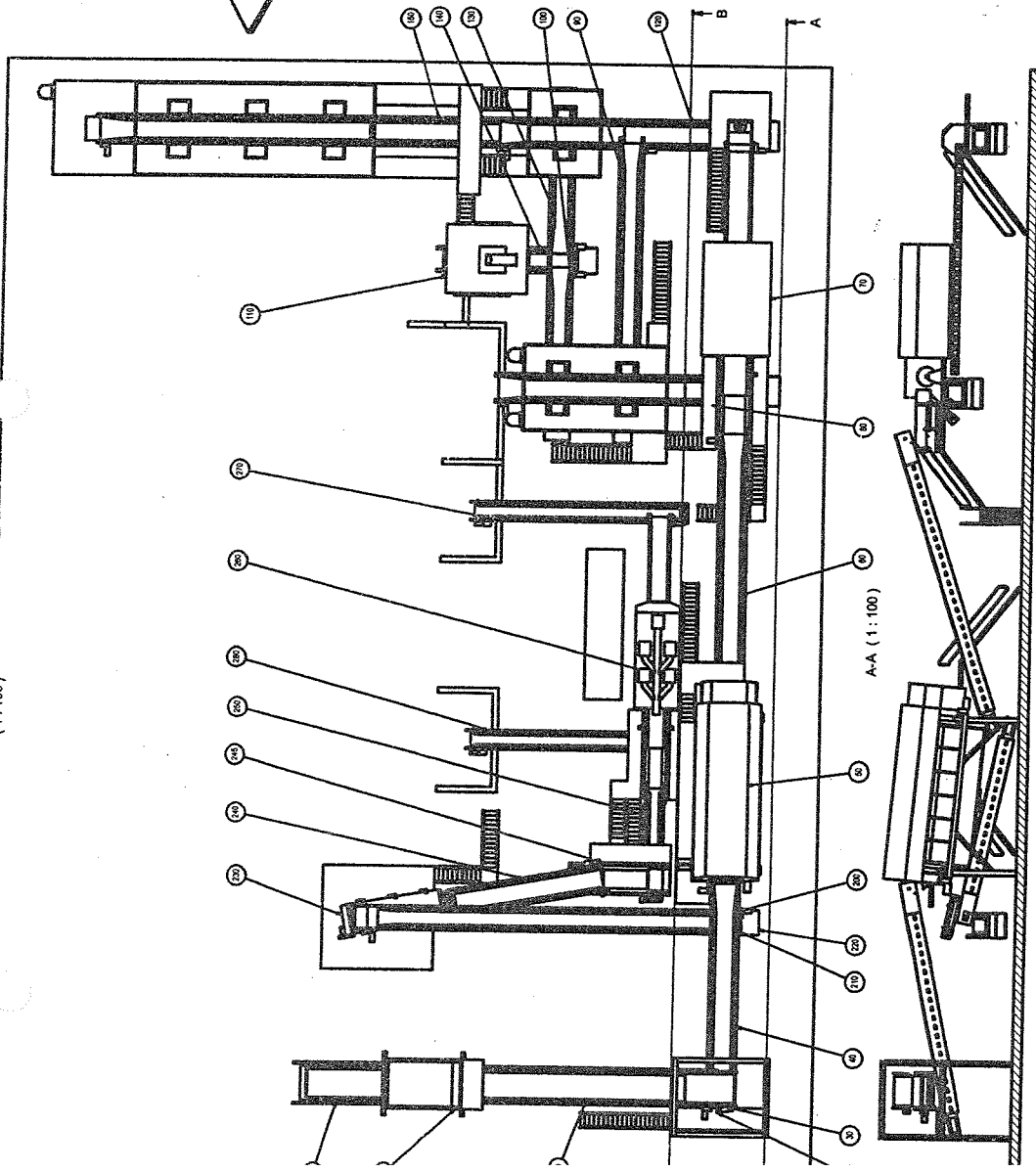

A-A (1:100)

B-B (1:100)

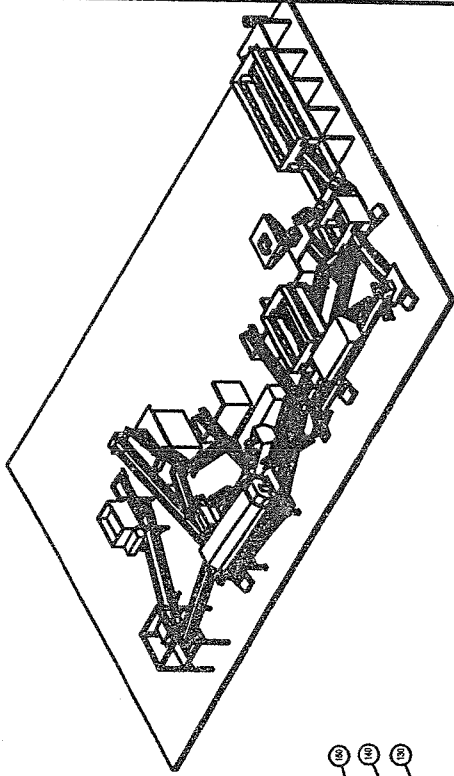
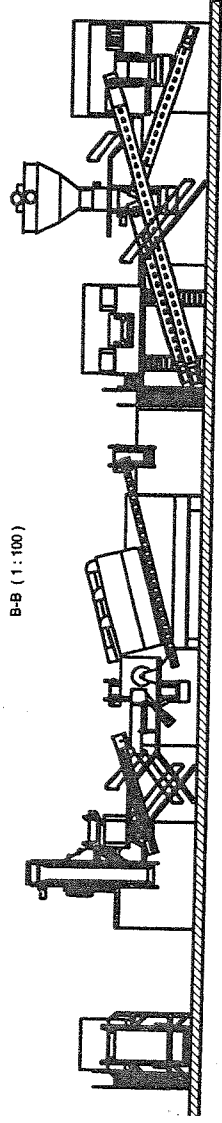

| Kaizen recycling Ltd |               | Project No. 10 |               | Drawing No. 10-100 |               |
|----------------------|---------------|----------------|---------------|--------------------|---------------|
| Layed JFE-Group      |               | Project Name   |               | Drawing Title      |               |
| 1                    | General       | 2              | Foundation    | 3                  | Structure     |
| 4                    | Roof          | 5              | Interior      | 6                  | Exterior      |
| 7                    | Plumbing      | 8              | Electrical    | 9                  | Sanitary      |
| 10                   | Painting      | 11             | Finishing     | 12                 | Equipment     |
| 13                   | Landscaping   | 14             | Site Plan     | 15                 | Section A-A   |
| 16                   | Section B-B   | 17             | Section C-C   | 18                 | Section D-D   |
| 19                   | Section E-E   | 20             | Section F-F   | 21                 | Section G-G   |
| 22                   | Section H-H   | 23             | Section I-I   | 24                 | Section J-J   |
| 25                   | Section K-K   | 26             | Section L-L   | 27                 | Section M-M   |
| 28                   | Section N-N   | 29             | Section O-O   | 30                 | Section P-P   |
| 31                   | Section Q-Q   | 32             | Section R-R   | 33                 | Section S-S   |
| 34                   | Section T-T   | 35             | Section U-U   | 36                 | Section V-V   |
| 37                   | Section W-W   | 38             | Section X-X   | 39                 | Section Y-Y   |
| 40                   | Section Z-Z   | 41             | Section AA-AA | 42                 | Section BB-BB |
| 43                   | Section CC-CC | 44             | Section DD-DD | 45                 | Section EE-EE |
| 46                   | Section FF-FF | 47             | Section GG-GG | 48                 | Section HH-HH |
| 49                   | Section II-II | 50             | Section JJ-JJ | 51                 | Section KK-KK |
| 52                   | Section LL-LL | 53             | Section MM-MM | 54                 | Section NN-NN |
| 55                   | Section OO-OO | 56             | Section PP-PP | 57                 | Section QQ-QQ |
| 58                   | Section RR-RR | 59             | Section SS-SS | 60                 | Section TT-TT |
| 61                   | Section UU-UU | 62             | Section VV-VV | 63                 | Section WW-WW |
| 64                   | Section XX-XX | 65             | Section YY-YY | 66                 | Section ZZ-ZZ |
| 67                   | Section AA-AA | 68             | Section BB-BB | 69                 | Section CC-CC |
| 70                   | Section DD-DD | 71             | Section EE-EE | 72                 | Section FF-FF |
| 73                   | Section GG-GG | 74             | Section HH-HH | 75                 | Section II-II |
| 76                   | Section JJ-JJ | 77             | Section KK-KK | 78                 | Section LL-LL |
| 79                   | Section MM-MM | 80             | Section NN-NN | 81                 | Section OO-OO |
| 82                   | Section PP-PP | 83             | Section QQ-QQ | 84                 | Section RR-RR |
| 85                   | Section SS-SS | 86             | Section TT-TT | 87                 | Section UU-UU |
| 88                   | Section VV-VV | 89             | Section WW-WW | 90                 | Section XX-XX |
| 91                   | Section YY-YY | 92             | Section ZZ-ZZ | 93                 | Section AA-AA |
| 94                   | Section BB-BB | 95             | Section CC-CC | 96                 | Section DD-DD |
| 97                   | Section EE-EE | 98             | Section FF-FF | 99                 | Section GG-GG |
| 100                  | Section HH-HH | 101            | Section II-II | 102                | Section JJ-JJ |
| 103                  | Section KK-KK | 104            | Section LL-LL | 105                | Section MM-MM |
| 106                  | Section NN-NN | 107            | Section OO-OO | 108                | Section PP-PP |
| 109                  | Section QQ-QQ | 110            | Section RR-RR | 111                | Section SS-SS |
| 112                  | Section TT-TT | 113            | Section UU-UU | 114                | Section VV-VV |
| 115                  | Section WW-WW | 116            | Section XX-XX | 117                | Section YY-YY |
| 118                  | Section ZZ-ZZ | 119            | Section AA-AA | 120                | Section BB-BB |
| 121                  | Section CC-CC | 122            | Section DD-DD | 123                | Section EE-EE |
| 124                  | Section FF-FF | 125            | Section GG-GG | 126                | Section HH-HH |
| 127                  | Section II-II | 128            | Section JJ-JJ | 129                | Section KK-KK |
| 130                  | Section LL-LL | 131            | Section MM-MM | 132                | Section NN-NN |
| 133                  | Section OO-OO | 134            | Section PP-PP | 135                | Section QQ-QQ |
| 136                  | Section RR-RR | 137            | Section SS-SS | 138                | Section TT-TT |
| 139                  | Section UU-UU | 140            | Section VV-VV | 141                | Section WW-WW |
| 142                  | Section XX-XX | 143            | Section YY-YY | 144                | Section ZZ-ZZ |
| 145                  | Section AA-AA | 146            | Section BB-BB | 147                | Section CC-CC |
| 148                  | Section DD-DD | 149            | Section EE-EE | 150                | Section FF-FF |
| 151                  | Section GG-GG | 152            | Section HH-HH | 153                | Section II-II |
| 154                  | Section JJ-JJ | 155            | Section KK-KK | 156                | Section LL-LL |
| 157                  | Section MM-MM | 158            | Section NN-NN | 159                | Section OO-OO |
| 160                  | Section PP-PP | 161            | Section QQ-QQ | 162                | Section RR-RR |
| 163                  | Section SS-SS | 164            | Section TT-TT | 165                | Section UU-UU |
| 166                  | Section VV-VV | 167            | Section WW-WW | 168                | Section XX-XX |
| 169                  | Section YY-YY | 170            | Section ZZ-ZZ | 171                | Section AA-AA |
| 172                  | Section BB-BB | 173            | Section CC-CC | 174                | Section DD-DD |
| 175                  | Section EE-EE | 176            | Section FF-FF | 177                | Section GG-GG |
| 178                  | Section HH-HH | 179            | Section II-II | 180                | Section JJ-JJ |
| 181                  | Section KK-KK | 182            | Section LL-LL | 183                | Section MM-MM |
| 184                  | Section NN-NN | 185            | Section OO-OO | 186                | Section PP-PP |
| 187                  | Section QQ-QQ | 188            | Section RR-RR | 189                | Section SS-SS |
| 190                  | Section TT-TT | 191            | Section UU-UU | 192                | Section VV-VV |
| 193                  | Section WW-WW | 194            | Section XX-XX | 195                | Section YY-YY |
| 196                  | Section ZZ-ZZ | 197            | Section AA-AA | 198                | Section BB-BB |
| 199                  | Section CC-CC | 200            | Section DD-DD | 201                | Section EE-EE |
| 202                  | Section FF-FF | 203            | Section GG-GG | 204                | Section HH-HH |
| 205                  | Section II-II | 206            | Section JJ-JJ | 207                | Section KK-KK |
| 208                  | Section LL-LL | 209            | Section MM-MM | 210                | Section NN-NN |
| 211                  | Section OO-OO | 212            | Section PP-PP | 213                | Section QQ-QQ |
| 214                  | Section RR-RR | 215            | Section SS-SS | 216                | Section TT-TT |
| 217                  | Section UU-UU | 218            | Section VV-VV | 219                | Section WW-WW |
| 220                  | Section XX-XX | 221            | Section YY-YY | 222                | Section ZZ-ZZ |
| 223                  | Section AA-AA | 224            | Section BB-BB | 225                | Section CC-CC |
| 226                  | Section DD-DD | 227            | Section EE-EE | 228                | Section FF-FF |
| 229                  | Section GG-GG | 230            | Section HH-HH | 231                | Section II-II |
| 232                  | Section JJ-JJ | 233            | Section KK-KK | 234                | Section LL-LL |
| 235                  | Section MM-MM | 236            | Section NN-NN | 237                | Section OO-OO |
| 238                  | Section PP-PP | 239            | Section QQ-QQ | 240                | Section RR-RR |
| 241                  | Section SS-SS | 242            | Section TT-TT | 243                | Section UU-UU |
| 244                  | Section VV-VV | 245            | Section WW-WW | 246                | Section XX-XX |
| 247                  | Section YY-YY | 248            | Section ZZ-ZZ | 249                | Section AA-AA |
| 250                  | Section BB-BB | 251            | Section CC-CC | 252                | Section DD-DD |
| 253                  | Section EE-EE | 254            | Section FF-FF | 255                | Section GG-GG |
| 256                  | Section HH-HH | 257            | Section II-II | 258                | Section JJ-JJ |
| 259                  | Section KK-KK | 260            | Section LL-LL | 261                | Section MM-MM |
| 262                  | Section NN-NN | 263            | Section OO-OO | 264                | Section PP-PP |
| 265                  | Section QQ-QQ | 266            | Section RR-RR | 267                | Section SS-SS |
| 268                  | Section TT-TT | 269            | Section UU-UU | 270                | Section VV-VV |
| 271                  | Section WW-WW | 272            | Section XX-XX | 273                | Section YY-YY |
| 274                  | Section ZZ-ZZ | 275            | Section AA-AA | 276                | Section BB-BB |
| 277                  | Section CC-CC | 278            | Section DD-DD | 279                | Section EE-EE |
| 280                  | Section FF-FF | 281            | Section GG-GG | 282                | Section HH-HH |
| 283                  | Section II-II | 284            | Section JJ-JJ | 285                | Section KK-KK |
| 286                  | Section LL-LL | 287            | Section MM-MM | 288                | Section NN-NN |
| 289                  | Section OO-OO | 290            | Section PP-PP | 291                | Section QQ-QQ |
| 292                  | Section RR-RR | 293            | Section SS-SS | 294                | Section TT-TT |
| 295                  | Section UU-UU | 296            | Section VV-VV | 297                | Section WW-WW |
| 298                  | Section XX-XX | 299            | Section YY-YY | 300                | Section ZZ-ZZ |
| 301                  | Section AA-AA | 302            | Section BB-BB | 303                | Section CC-CC |
| 304                  | Section DD-DD | 305            | Section EE-EE | 306                | Section FF-FF |
| 307                  | Section GG-GG | 308            | Section HH-HH | 309                | Section II-II |
| 310                  | Section JJ-JJ | 311            | Section KK-KK | 312                | Section LL-LL |
| 313                  | Section MM-MM | 314            | Section NN-NN | 315                | Section OO-OO |
| 316                  | Section PP-PP | 317            | Section QQ-QQ | 318                | Section RR-RR |
| 319                  | Section SS-SS | 320            | Section TT-TT | 321                | Section UU-UU |
| 322                  | Section VV-VV | 323            | Section WW-WW | 324                | Section XX-XX |
| 325                  | Section YY-YY | 326            | Section ZZ-ZZ | 327                | Section AA-AA |
| 328                  | Section BB-BB | 329            | Section CC-CC | 330                | Section DD-DD |
| 331                  | Section EE-EE | 332            | Section FF-FF | 333                | Section GG-GG |
| 334                  | Section HH-HH | 335            | Section II-II | 336                | Section JJ-JJ |
| 337                  | Section KK-KK | 338            | Section LL-LL | 339                | Section MM-MM |
| 340                  | Section NN-NN | 341            | Section OO-OO | 342                | Section PP-PP |
| 343                  | Section QQ-QQ | 344            | Section RR-RR | 345                | Section SS-SS |
| 346                  | Section TT-TT | 347            | Section UU-UU | 348                | Section VV-VV |
| 349                  | Section WW-WW | 350            | Section XX-XX | 351                | Section YY-YY |
| 352                  | Section ZZ-ZZ | 353            | Section AA-AA | 354                | Section BB-BB |
| 355                  | Section CC-CC | 356            | Section DD-DD | 357                | Section EE-EE |
| 358                  | Section FF-FF | 359            | Section GG-GG | 360                | Section HH-HH |
| 361                  | Section II-II | 362            | Section JJ-JJ | 363                | Section KK-KK |
| 364                  | Section LL-LL | 365            | Section MM-MM | 366                | Section NN-NN |
| 367                  | Section OO-OO | 368            | Section PP-PP | 369                | Section QQ-QQ |
| 370                  | Section RR-RR | 371            | Section SS-SS | 372                | Section TT-TT |
| 373                  | Section UU-UU | 374            | Section VV-VV | 375                | Section WW-WW |
| 376                  | Section XX-XX | 377            | Section YY-YY | 378                | Section ZZ-ZZ |
| 379                  | Section AA-AA | 380            | Section BB-BB | 381                | Section CC-CC |
| 382                  | Section DD-DD | 383            | Section EE-EE | 384                | Section FF-FF |
| 385                  | Section GG-GG | 386            | Section HH-HH | 387                | Section II-II |
| 388                  | Section JJ-JJ | 389            | Section KK-KK | 390                | Section LL-LL |
| 391                  | Section MM-MM | 392            | Section NN-NN | 393                | Section OO-OO |
| 394                  | Section PP-PP | 395            | Section QQ-QQ | 396                | Section RR-RR |
| 397                  | Section SS-SS | 398            | Section TT-TT | 399                | Section UU-UU |
| 400                  | Section VV-VV | 401            | Section WW-WW | 402                | Section XX-XX |
| 403                  | Section YY-YY | 404            | Section ZZ-ZZ | 405                | Section AA-AA |
| 406                  | Section BB-BB | 407            | Section CC-CC | 408                | Section DD-DD |
| 409                  | Section EE-EE | 410            | Section FF-FF | 411                | Section GG-GG |
| 412                  | Section HH-HH | 413            | Section II-II | 414                | Section JJ-JJ |
| 415                  | Section KK-KK | 416            | Section LL-LL | 417                | Section MM-MM |
| 418                  | Section NN-NN | 419            | Section OO-OO | 420                | Section PP-PP |
| 421                  | Section QQ-QQ | 422            | Section RR-RR | 423                | Section SS-SS |
| 424                  | Section TT-TT | 425            | Section UU-UU | 426                | Section VV-VV |
| 427                  | Section WW-WW | 428            | Section XX-XX | 429                | Section YY-YY |
| 430                  | Section ZZ-ZZ | 431            | Section AA-AA | 432                | Section BB-BB |
| 433                  | Section CC-CC | 434            | Section DD-DD | 435                | Section EE-EE |
| 436                  | Section FF-FF | 437            | Section GG-GG | 438                | Section HH-HH |
| 439                  | Section II-II | 440            | Section JJ-JJ | 441                | Section KK-KK |
| 442                  | Section LL-LL | 443            | Section MM-MM | 444                | Section NN-NN |
| 445                  | Section OO-OO | 446            | Section PP-PP | 447                | Section QQ-QQ |
| 448                  | Section RR-RR | 449            | Section SS-SS | 450                | Section TT-TT |
| 451                  | Section UU-UU | 452            | Section VV-VV | 453                | Section WW-WW |
| 454                  | Section XX-XX | 455            | Section YY-YY | 456                | Section ZZ-ZZ |
| 457                  | Section AA-AA | 458            | Section BB-BB | 459                | Section CC-CC |
| 460                  | Section DD-DD | 461            | Section EE-EE | 462                | Section FF-FF |
| 463                  | Section GG-GG | 464            | Section HH-HH | 465                | Section II-II |
| 466                  | Section JJ-JJ | 467            | Section KK-KK | 468                | Section LL-LL |
| 469                  | Section MM-MM | 470            | Section NN-NN | 471                | Section OO-OO |
| 472                  | Section PP-PP | 473            | Section QQ-QQ | 474                | Section RR-RR |
| 475                  | Section SS-SS | 476            | Section TT-TT | 477                | Section UU-UU |
| 478                  | Section VV-VV | 479            | Section WW-WW | 480                | Section XX-XX |
| 481                  | Section YY-YY | 482            | Section ZZ-ZZ | 483                | Section AA-AA |
| 484                  | Section BB-BB | 485            | Section CC-CC | 486                | Section DD-DD |
| 487                  | Section EE-EE | 488            | Section FF-FF | 489                | Section GG-GG |
| 490                  | Section HH-HH | 491            | Section II-II | 492                | Section JJ-JJ |
| 493                  | Section KK-KK | 494            | Section LL-LL | 495                | Section MM-MM |
| 496                  | Section NN-NN | 497            | Section OO-OO | 498                | Section PP-PP |
| 499                  | Section QQ-QQ | 500            | Section RR-RR | 501                | Section SS-SS |
| 502                  | Section TT-TT | 503            | Section UU-UU | 504                | Section VV-VV |
| 505                  | Section WW-WW | 506            | Section XX-XX | 507                | Section YY-YY |
| 508                  | Section ZZ-ZZ | 509            | Section AA-AA | 510                | Section BB-BB |
| 511                  | Section CC-CC | 512            | Section DD-DD | 513                | Section EE-EE |
| 514                  | Section FF-FF | 515            | Section GG-GG | 516                | Section HH-HH |
| 517                  | Section II-II | 518            | Section JJ-JJ | 519                | Section KK-KK |
| 520                  | Section LL-LL | 521            | Section MM-MM | 522                | Section NN-NN |
| 523                  | Section OO-OO | 524            | Section PP-PP | 525                | Section QQ-QQ |
| 526                  | Section RR-RR | 527            | Section SS-SS | 528                | Section TT-TT |
| 529                  | Section UU-UU | 530            | Section VV-VV | 531                | Section WW-WW |
| 532                  | Section XX-XX | 533            | Section YY-YY | 534                | Section ZZ-ZZ |
| 535                  | Section AA-AA | 536            | Section BB-BB | 537                | Section CC-CC |
| 538                  | Section DD-DD | 539            | Section EE-EE | 540                | Section FF-FF |
| 541                  | Section GG-GG | 542            | Section HH-HH | 543                | Section II-II |
| 544                  | Section JJ-JJ | 545            | Section KK-KK | 546                | Section LL-LL |
| 547                  | Section MM-MM | 548            | Section NN-NN | 549                | Section OO-OO |
| 550                  | Section PP-PP | 551            | Section QQ-QQ | 552                | Section RR-RR |
| 553                  | Section SS-SS | 554            | Section TT-TT | 555                | Section UU-UU |
| 556                  | Section VV-VV | 557            | Section WW-WW | 558                | Section XX-XX |
| 559                  | Section YY-YY | 560            | Section ZZ-ZZ | 561                | Section AA-AA |
| 562                  | Section BB-BB | 563            | Section CC-CC | 564                | Section DD-DD |
| 565                  | Section EE-EE | 566            | Section FF-FF | 567                | Section GG-GG |
| 568                  | Section HH-HH | 569            | Section II-II | 570                | Section JJ-JJ |
| 571                  | Section KK-KK | 572            | Section LL-LL | 573                | Section MM-MM |
| 574                  | Section NN-NN | 575            | Section OO-OO | 576                | Section PP-PP |
| 577                  | Section QQ-QQ | 578            | Section RR-RR | 579                | Section SS-SS |
| 580                  | Section TT-TT | 581            | Section UU-UU | 582                | Section VV-VV |
| 583                  | Section WW-WW | 584            | Section XX-XX | 585                | Section YY-YY |
| 586                  | Section ZZ-ZZ | 587            | Section AA-AA | 588                | Section BB-BB |
| 589                  | Section CC-CC | 590            | Section DD-DD | 591                | Section EE-EE |
| 592                  | Section FF-FF | 593            | Section GG-GG | 594                | Section HH-HH |
| 595                  | Section II-II | 596            | Section JJ-JJ | 597                | Section KK-KK |
| 598                  | Section LL-LL | 599            | Section MM-MM | 600                | Section NN-NN |
| 601                  | Section OO-OO | 602            | Section PP-PP | 603                | Section QQ-QQ |
| 604                  | Section RR-RR | 605            | Section SS-SS | 606                | Section TT-TT |
| 607                  | Section UU-UU | 608            | Section VV-VV | 609                | Section WW-WW |
| 610                  | Section XX-XX | 611            | Section YY-YY | 612                | Section ZZ-ZZ |
| 613                  | Section AA-AA | 614            | Section BB-BB | 615                | Section CC-CC |
| 616                  | Section DD-DD | 617            | Section EE-EE | 618                | Section FF-FF |
| 619                  | Section GG-GG | 620            | Section HH-HH | 621                | Section II-II |
| 622                  | Section JJ-JJ | 623            | Section KK-KK | 624                | Section LL-LL |
| 625                  | Section MM-MM | 626            | Section NN-NN | 627                | Section OO-OO |
| 628                  | Section PP-PP | 629            | Section QQ-QQ | 630                |               |

# JPE Holdings

60 to 80 TPH @ 600 to 800 kg/m<sup>3</sup> (100m<sup>3</sup>/h) C&D / Skip Waste

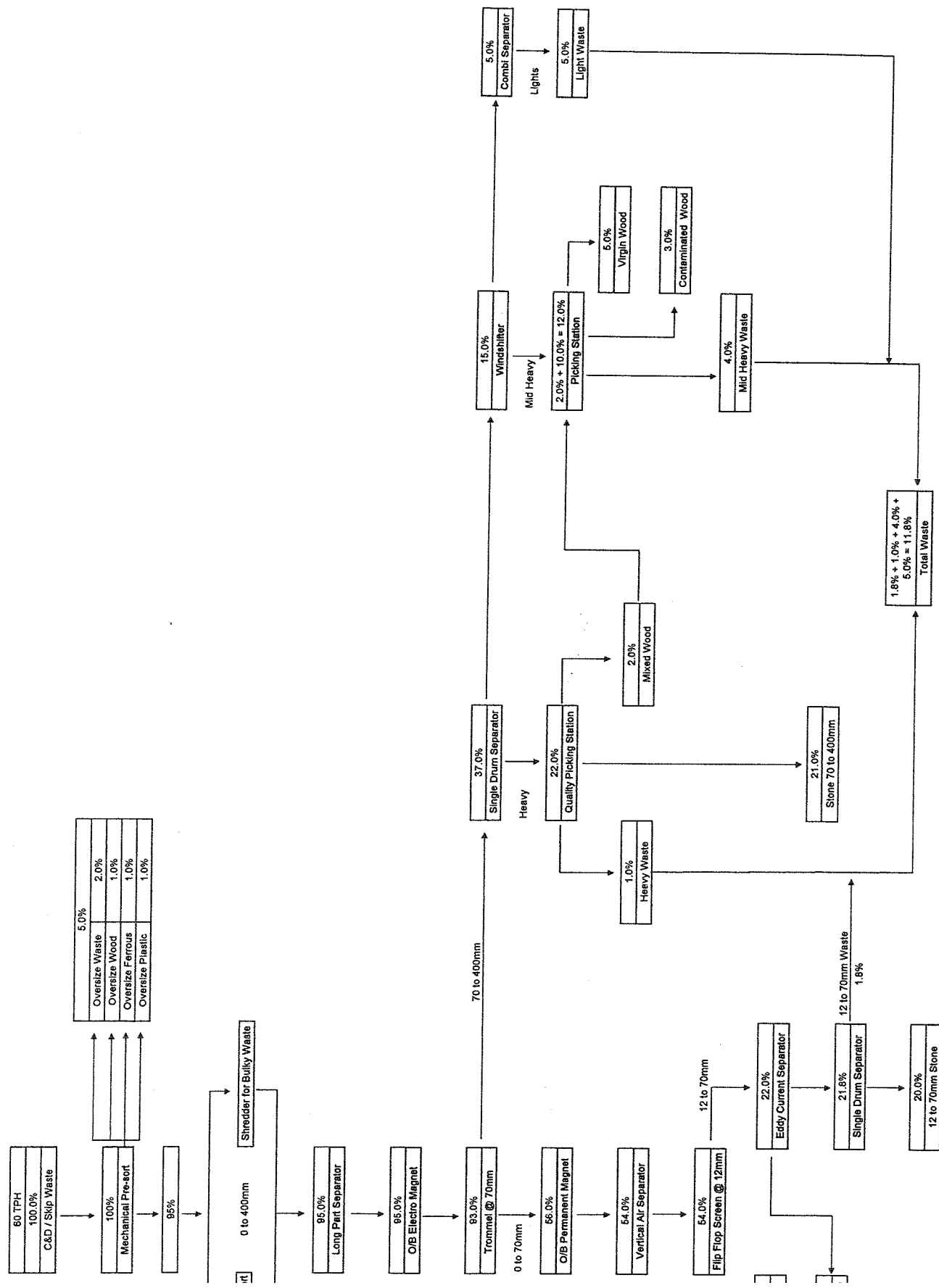

## **Appendix 3**

### **Risk Assessment**

| Source  | Hazardous Event or Pathway  | Receptor  | Generic Risk Assessment for Waste Type Handled  | Risk management system to control assessed Risk*   | Risk factor   |
|---|---|---|---|--|---|
| Non-inert wastes likely to produce polluting run off              | Release of contaminated site run off to the environment via ground and surface water  | Properties<br>Ecosystems<br>Surface water<br>Ground water<br>(people via above)   | Very Low Risk of site run off to adjacent properties                                      | Wastes only permitted if free from excessive contaminants<br>Stored only in specified area comprising:<br>Concrete pad with controlled drainage to sewer                                       | Properties - Very Low<br>Ecosystems - Low<br>Surface waters - Low<br>Ground waters - Low  |
|   |   |   | Very Low Risk of site run off to adjoining properties                                     | As above   |   |
|   |   |   | Low risk of groundwater pollution   | As all above<br>Controlled by:<br>Retention of surface waters in drainage system<br>Regular inspection of drains.<br>(See Section 2 in Working Plan)   |   |
|   |   |   | Low Risk of adjacent surface water pollution  |  |   |
| Unlicensed wastes   | Biodegradation during storage producing leachate  | Properties<br>People<br>Ecosystems  | Low Risk due to careful control at waste reception<br>short storage duration              | Management of waste inspection procedures with regular customers and inhouse collection of wastes<br>(See Section 4.4 in Working Plan)   | Properties - Low<br>People - Low<br>Ecosystems - Low  |
| Combustible Wastes<br>such as wood<br>paper, plastics             | Combustion or fires in stockpiles leading to direct damage and polluting releases to the environment                            | Properties<br>People<br>Ecosystems<br>Surface water<br>Ground water<br>Atmosphere | Mod/Low risk due to nature of waste streams received                                      | Secure boundary fence and storage within buildings<br>(See Section 4.3 in Working Plan)  | Properties - Mod/Low<br>People - Low<br>Ecosystems - Low<br>Surface waters - Low<br>Ground waters - Low<br>Atmosphere - Mod/Low |
| Unpermitted Wastes  | Inclusion with inert wastes   | Properties<br>Ecosystems<br>(people via above)                                    | Very Low Risk due to careful control at waste reception                                   | Management of incoming wastes and inspection<br>Isolation within existing MRF if received<br>Disposal following advice from Agency<br>(See Sections 1.2 and 4.4 in Working Plan)               | Properties - Very Low<br>Ecosystems - Very Low<br>(people - Very Low)   |
| Dust and Particulates   | Release of dust and particulates to atmosphere during unloading, treatment and reloading.<br>Movement of vehicles and equipment | Properties<br>People<br>Ecosystems  | Low Risk beyond site boundary due to on site measures                                     | Dampening of stockpiles and transfers using spray hoses as indicated in Working Plan<br>Sheeting of vehicles and skips, speed limits at 5 mph within site<br>(See Section 5.1 in Working Plan) | Properties - Low<br>People - Low<br>Ecosystems - Low  |
| Wastes likely to produce offensive or harmful odours              | Release of odours to atmosphere which may be unpleasant or harmful beyond site boundary   | People  | Very Low Risk due to careful control at waste reception                                   | Management of incoming wastes and inspection. If odour is noted, material to be identified, isolated and removed from site immediately<br>(See Section 5.2 in Working Plan)                    | People - Very Low   |
| Wastes or operations on site likely to give rise to mud or debris | Deposition of mud or debris on highway or other public areas outside the site   | Properties<br>People  | Moderate/Low Risk due to management of site operations and vehicle movements/housekeeping | Good housekeeping, sheeting of vehicles, fully surfaced site, pressure hose available in extreme<br>(See Section 4.1 in Working Plan)  | Properties - Mod/Low<br>People - Low  |
| Wastes likely to attract pests                                    | Installation by pest and migration outside site boundary  | Properties<br>People<br>Ecosystems  | Low Risk due to careful control at waste reception and site management                    | Management of incoming wastes and inspection<br>Monitoring and control as required<br>(See Section 5.4 in Working Plan)  | Properties - Low<br>People - Low<br>Ecosystems - Low  |



| Source   | Hazardous Event or Pathway  | Receptor  | Generic Risk Assessment for Waste Type Handled   | Risk management system to control assessed Risk*   | Risk factor   |
|--|---|---|--|--|---|
| Light wastes likely to generate significant amounts of litter                      | Escape of blown litter beyond site boundary   | Properties<br>People<br>Ecosystems  | Low Risk due to careful control at waste reception and site management                                   | Regular housekeeping litter patrols in and around site<br>Waste received into and stored within building<br>(See Section 5.5 in Working Plan)  | Properties - Low<br>People - Low<br>Ecosystems - Low  |
| Fuels and Oils stored on site  | Release or escape of fuel oil and lubricants to ground or surface waters  | Properties<br>Ecosystems  | Low risk due to design and storage of fuels and lubricants<br>Mod/Low risk from burst hoses on equipment | Bundled fuel storage to Agency requirements<br>Dedicated lubricant store<br>Equipment maintained in dedicated workshops<br>Used materials (oils and filters) stored in containers and removed from site<br>Impermeable base with contained drains to sewer<br>Oil absorbents available within complex<br>(See Section 4.2 in Working Plan) | Properties - Low<br>Ecosystems - Mod/Low  |
| Noise pollution arising from receipt, handling, treatment or dispatch of materials | Noise pollution beyond site boundary  | Properties<br>People  | Mod/low risk due to careful maintenance of equipment   | Location of process operations within buildings<br>Few sensitive receptors in area<br>Noise attenuation systems fitted and maintained on all equipment to manufacturer's specifications<br>(See Section 5.3 in Working Plan)   | Properties - Low<br>People - Mod/Low  |
| Risks associated with storage and processing                                       | Noise, dust, debris, leakages of fuel or oils from equipment<br>degradation of stored wastes causing odours or leachates<br>infestation or nesting of pests | Properties<br>People<br>Ecosystems<br>Surface water<br>Ground water<br>Atmosphere | Various as listed above  | Risk management as detailed in above sections  | Properties - Low<br>People - Low<br>Ecosystems - Low<br>Surface waters - Low<br>Ground waters - Low<br>Atmosphere - Low |

*NA*

## **Figures**



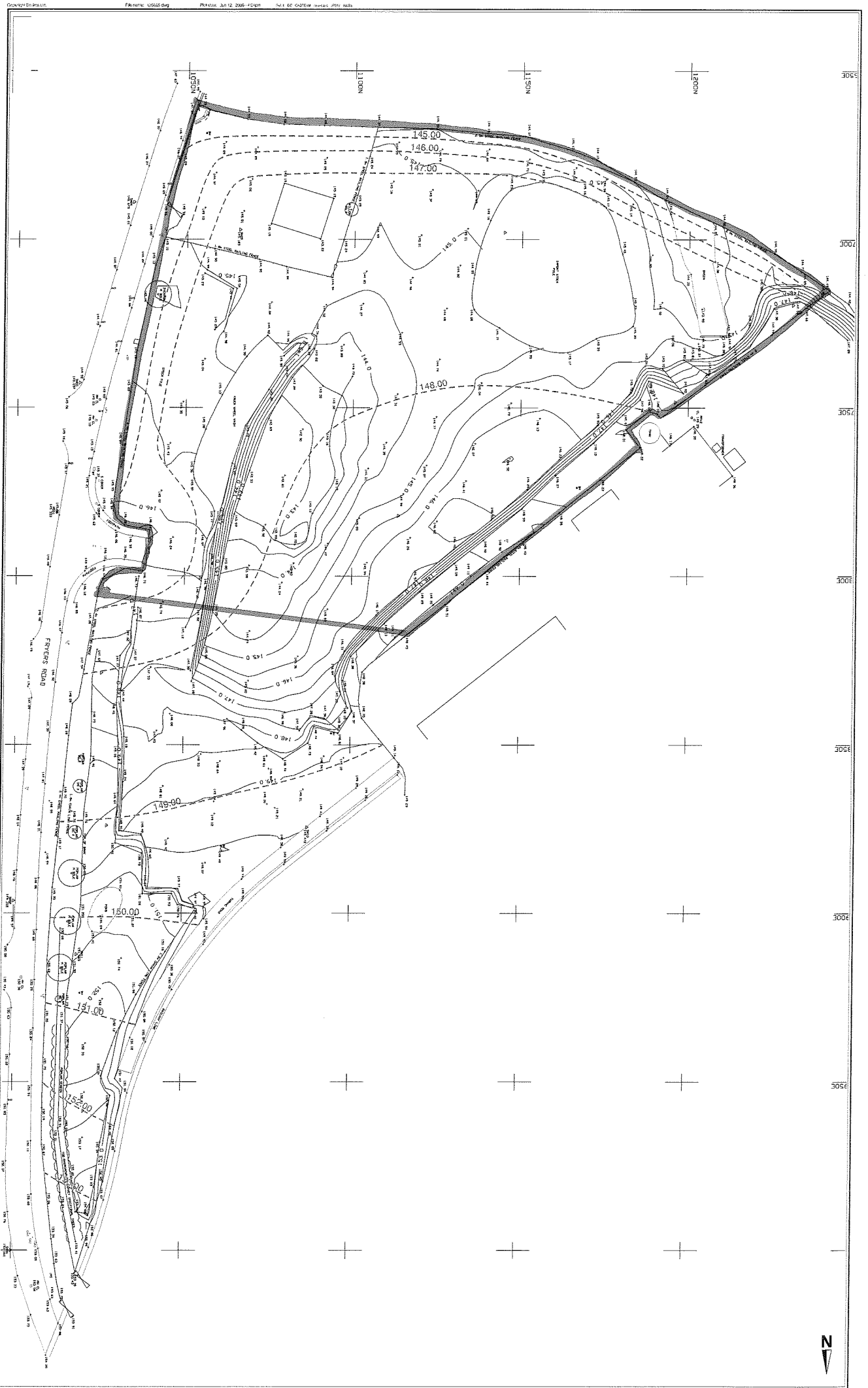

Proposed Contours mAD

NOTES:  
 1. Survey Drawing 99051A provided by the client.  
 2. January 2006  
 3. Survey is based on a 1:50,000 scale map.  
 4. Survey is based on a 1:50,000 scale map.

JPE HOLDINGS

SCALE 1:500 DATE 2/1/2006

Fryers Road MRF and Washing Plant

JPE/MRF/02 Site Bound