



WALSALL METROPOLITAN BOROUGH COUNCIL

CONTROL OF POLLUTION ACT 1974

LICENCE TO DISPOSE OF WASTE

THE METROPOLITAN BOROUGH COUNCIL OF WALSALL in pursuance of the powers conferred on them by the Control of Pollution Act 1974, hereby license Mr P W Peters, Whitby Riding Stables, Aldridge Road, Walsall (hereinafter called the "licence holder") to dispose of controlled waste on land at Whitby Riding Stables, Aldridge Road, Walsall which is shown edged red on the drawing attached to this licence, being land occupied by the licence holder.

This licence is granted subject to the conditions set out in the schedules attached hereto.

Dated this *Sixteenth* day of *November* 19*90*

*K. B. Khan*  
.....  
Director of Environmental Health  
and Consumer Services

The licence holder's attention is drawn to the notes overleaf

LL8AAD



NOTES

These notes are for general guidance only and they do not constitute an authoritative statement of the law.

This licence permits the deposit of certain wastes under controlled conditions and is not intended to permit the sorting, storing, transfer or treatment of wastes except to the extent expressly referred to in the Schedules.

Definitions of certain words used in this licence are to be found in Schedule B.

This licence relates only to the requirements of the Control of Pollution Act 1974 for the deposit of waste and the use of plant or equipment subject to the conditions set out in the Schedules and does not constitute a consent required by any other legislation. In particular it is the responsibility of the licence holder to comply with any requirements of the Health and Safety at Work etc Act 1974, the Radioactive Substances Act 1960, the Town and Country Planning Acts, and all relevant water protection and environmental health legislation.

Particular attention is drawn to the problems associated with landfill gas, and the licence holder is strongly advised to familiarise himself with the contents of Waste Management Papers Numbers 26 and 27 and to review control measures in the light of evolving technology and procedures.

If the licence holder ceases to occupy the land specified above, then he may transfer the licence to the new occupier after giving notice to the Waste Disposal Authority who has the right to decline to accept the new licence holder.

If the licence holder wishes to cancel this licence, he must return it to the Waste Disposal Authority together with a notice stating he no longer requires the licence. Cancellation of the licence will not affect any outstanding liability of the licence holder under the conditions of the licence.



Contravention of Licence Conditions

Your attention is drawn to the provisions of Section 3, 9 and 16 of the Control of Pollution Act, 1974.

Section 3

Prohibits under penalty the deposit of waste, or the use of plant or equipment, otherwise than in accordance with the terms of a licence. This Section applies to all the conditions contained herein, including any which may be the subject of appeal to the Secretary of State under Section 10 of the Act.

Any deposit which takes place without compliance with all the licence conditions may lead to prosecution under this Section. A person who contravenes Section 3 subsection (1) shall, subject to subsection (4) be guilty of an offence and liable on summary conviction to a fine of an amount not exceeding £2,000 (at the date of issue of this licence), or on conviction on indictment to imprisonment for a term not exceeding two years or a fine or both.

Section 9

Non compliance with any licence conditions may lead to the revocation of this licence.

Section 16

The licensing authority is empowered to require the removal of any controlled waste deposited in circumstances where any of the conditions contained in this licence are not being complied with, or the undertaking of such works as are required to reduce or eliminate the consequences of such deposits.



Conditions for landfill at:

Whitby Riding Stables,  
Aldridge Road,  
Walsall.

Licence Holder:

Mr P W Peters,  
Whitby Riding Stables,  
Aldridge Road,  
Walsall.

Licence No.:

SL 889

Schedule A

- 1(a) The statement of intended methods of operation and accompanying drawings entitled "Landfill Site at Whitby Riding Stables - working plan" dated 19th March 1990 and the letter and accompanying drawings from Clayton, Bostock, Hill & Rigby to the applicant dated 19th September 1990 submitted as part of the application for this licence shall be referred to as the working plan.
- (b) Prior to any operations taking place under the terms of this licence the working plan shall have been approved in writing by the Waste Disposal Authority ('the WDA'). The licence holder shall obtain written approval from the WDA for any proposed change in the actual conduct of the operations from the proposals approved in the working plan, as altered by any previous changes approved by the WDA, before such change is implemented.
- (c) Any reference in this licence to the working plan shall include a reference to any amendment to the statement or the drawings which have been approved in writing by the WDA as appropriate.
- (d) Subject to the terms of this licence, the site shall be operated in accordance with the working plan.
2. The quantity of waste deposited daily at the site shall not exceed 60 cubic metres consisting only of construction wastes.

This waste shall not contain any hazardous quantity or concentration of poisonous, noxious or polluting substance and shall be free from biodegradable waste.

3. No waste liquids or sludges shall be imported onto or deposited at the site.



4. The deposit of waste and other operations at the site shall take place only on Mondays to Fridays between the hours of 0800 and 1700. Except in circumstances of emergency no deposit of waste or other operations shall take place outside these hours or on Saturdays, Sundays, Good Friday, Christmas Day, Bank Holidays or other public holidays. All circumstances of emergency shall be reported forthwith in writing to the WDA.
5. Notwithstanding condition 4, no deposit of waste or other operations shall be carried out during the hours of darkness as defined by the statutory lighting up times published by the Science Engineering Research Council.
6. The facility, when open, shall be staffed and supervised by at least one member of staff who is fully conversant with inspection and unloading procedures, capable of identifying the categories of waste permitted by this licence and trained to implement emergency procedures if necessary, as detailed in the working plan.
7. The site boundary, consisting of natural 1.5 metre high hedgerow shall be maintained to prevent unauthorised access and/or flytipping. An entrance gate shall be provided and shall be secured outside operating hours and when the site is unattended.
8. Vehicular access to the site shall be via the existing access off Aldridge Road.
9. Wastes shall be deposited, layered and compacted as detailed in the working plan.
10. Vent trenches for the control of landfill gas shall be constructed and maintained as detailed in the working plan.
11. A series of relief gas wells shall be constructed, located and maintained as detailed in the working plan to allow landfill gas to vent to atmosphere.
12. Standpipes shall be constructed, located and maintained as detailed in the working plan. The standpipes shall be monitored to determine concentrations of methane, carbon dioxide and oxygen at intervals of 2 weeks for an initial period of 3 months and thereafter as directed by the WDA. Atmospheric pressure at the time of monitoring shall be recorded.
13. Results of all monitoring shall be notified in writing to the WDA as soon as practicable after monitoring has taken place and in any case within one week.



14. All wastes accepted at the facility shall be checked immediately upon arrival for suitability for acceptance, as detailed in the working plan.
15. Provision, as detailed in the working plan, shall be made for dealing with any unacceptable waste inadvertently delivered to or left at the site.
16. Tanks and drums used for the storage of waste liquids and of liquids required for the operation of plant and equipment shall be of a type and construction suitable for the liquids they contain. They shall be labelled to show their contents and banded to ensure that any spillages are contained. The minimum capacity of a bund shall be equal to the volume of the largest tank or drum within that bund plus ten percent. Spillages in banded areas shall be removed forthwith and rainwater shall not be allowed to accumulate.
17. Site drainage shall be constructed and maintained as detailed in the working plan. All discharges to water courses shall meet the requirements of the National Rivers Authority.
18. No waste material shall be burnt within the boundaries of the facility. Any fire occurring within the confines of the facility shall be treated as an emergency and immediate action shall be taken to extinguish it. All outbreaks of fire shall be reported immediately to the Fire Service and the WDA.
19. Measures shall be taken to control dust, insects, vermin and odours as detailed in the working plan.
20. Measures shall be taken as detailed in the working plan to ensure that mud, debris or any other material is not deposited on any surrounding roadway by vehicles leaving the facility.
21. Measures, including proper maintenance and use, shall be undertaken to control the noise of plant, equipment and vehicles operating at the facility.
22. Records shall be kept of the types and quantities of all wastes delivered to the site. These records shall comprise full details as required on forms supplied by the WDA and copies shall be sent to the WDA once a month or at a frequency specified by the WDA. These records shall be made available to any representative of the WDA for inspection at the facility at any reasonable time.
23. Provision shall be made to allow safe access to all operational areas of the site at all reasonable times by authorised persons for the purpose of monitoring conditions at the site or its environs.





24. Final restoration, including soil/topsoil cover shall not exceed the levels shown on Drawing No.427/11. Levels shall not be raised within 2 metres of the land occupied by Midlands Electricity Board.
25. Any temporary cessation of operations for a period in excess of 3 months shall be notified to the WDA. Not less than 14 days notice shall be given to the WDA of the date on which operations are to recommence in the event of a temporary cessation for a period in excess of 3 months.
26. A copy of any notice or instruction received in respect of the facility from any authority other than the WDA, which in any way relates to the use of the facility, shall be given to the WDA within three days of the receipt of such notice or instruction.
27. The terms of this licence shall be made known to any person who is given responsibility for the management or control of this facility, and a copy of these conditions and the working plan shall be made available to any person working at the facility.

#### Schedule B

1. In this licence, an emergency is defined as a case where a person has reasonable cause to believe that circumstances exist which are likely to endanger life or health or cause damage to property or pollution of water.
2. A quantity or concentration of any substance contained in any waste is regarded to be hazardous if that substance is present in that waste in such a quantity or concentration as to subject persons or animals to material risk of death, injury or impairment of health, or as to threaten the pollution or contamination (whether on the surface or underground) of any water supply.
3. In this licence, landfill gas means gas having the characteristics of gas produced as a by-product from the digestion by anaerobic bacteria of putrescible matter present in waste deposited at landfill sites.

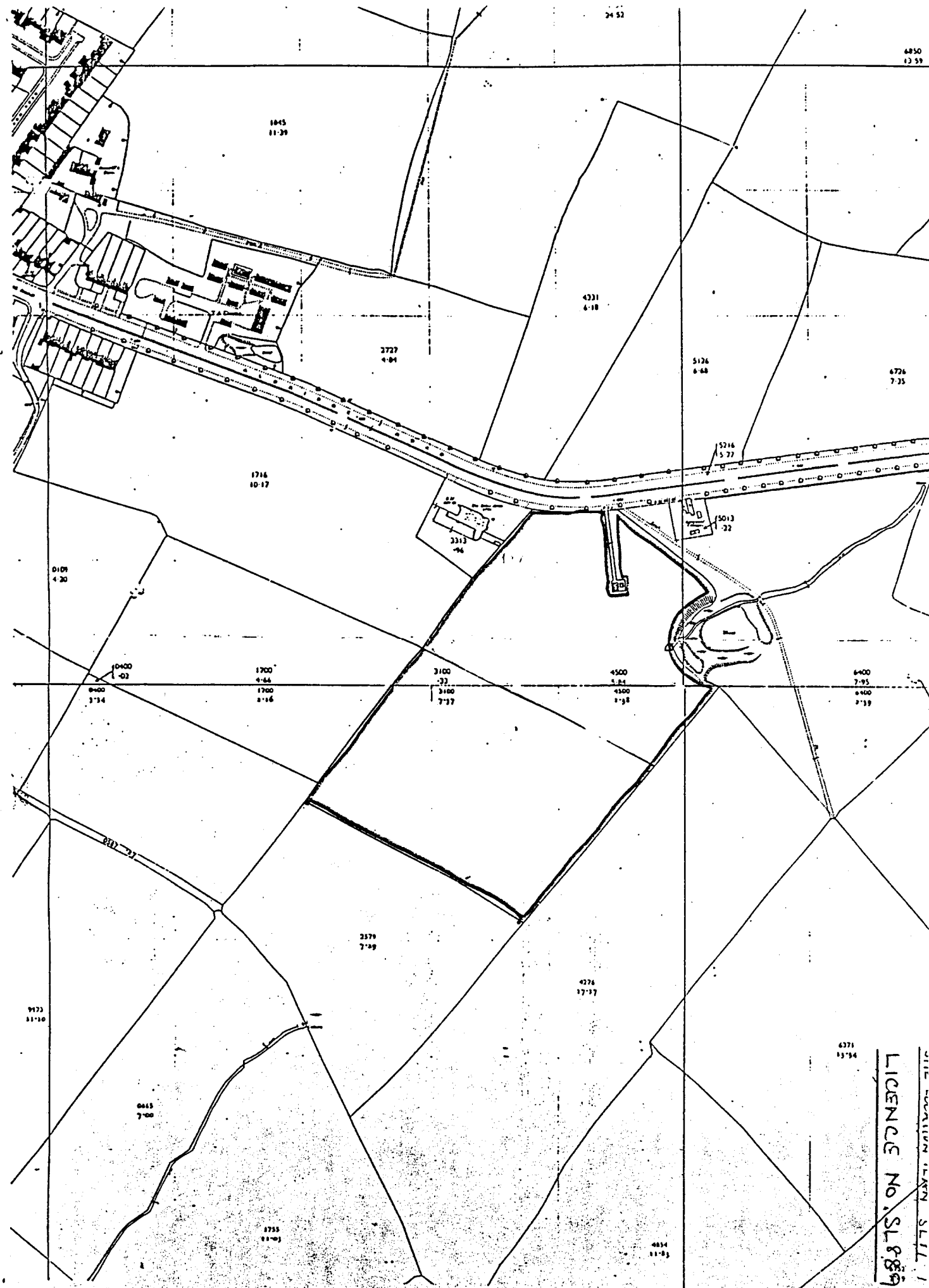

THE LOCATION MAP SHEET 1  
LICENCE NO. SL 889